

SERVICE MANUAL & PARTS LIST

MODEL: MyLock 344D

CONTENTS

TO CHANGE THE FACE PLATE UNIT	1
TO CHANGE THE BACK COVER UNIT	2
TO CHANGE THE TOP COVER.....	3
TO CHANGE THE FRONT COVER UNIT	4
TO CHANGE THE SIDE COVER UNIT	5
TO CHANGE THE MACHINE BASE	6
TO CHANGE THE MACHINE SOCKET	7
TO ADJUST THE NEEDLE HEIGHT	8
TO ADJUST THE PRESSER BAR HEIGHT	9
TO ADJUST THE FEED DOG HEIGHT.....	10
TO ADJUST THE TIMING OF THE NEEDLE AND THE FEED DOG.....	11
TO ADJUST THE TIMING OF THE NEEDLE AND THE UPPER KNIFE.....	12
TO ADJUST THE HEIGHT OF THE LOWER LOOPER	13
TO ADJUST THE CLEARANCE BETWEEN THE NEEDLES AND THE LOWER LOOPER/NEEDLE GUARDS	14-16
TO ADJUST THE CLEARANCE BETWEEN THE NEEDLES AND THE FIXED NEEDLE GUARD	17
TO ADJUST THE POSITION OF THE CHAINING FINGER.....	18
TO ADJUST THE POSITION OF THE UPPER LOOPER	19
TO ADJUST THE TIMING OF THE NEEDLE AND THE LOWER LOOPER	20
TO ADJUST THE TIMING OF THE UPPER AND LOWER LOOPERS	21
TO ADJUST THE CLEARANCE BETWEEN THE LOOPERS.....	22
TO ADJUST THE CLEARANCE BETWEEN THE NEEDLE AND THE UPPER LOOPER.....	23
TO ADJUST THE POSITION OF THE KNIVES.....	24
TO ADJUST THE POSITION OF THE LOWER LOOPER THREAD GUIDE....	25
TO ADJUST THE STITCH LENGTH	26
TO ADJUST THE THREAD TENSION DIALS	27
PARTS LIST	28-49

TO CHANGE THE FACE PLATE UNIT

To remove:

1. Loosen setscrew A and remove the face plate unit.

To attach:

2. Fit the U-groove of the face plate between setscrew A and set plate, put the rib of face plate into the front cover unit and back cover unit and tighten setscrew.

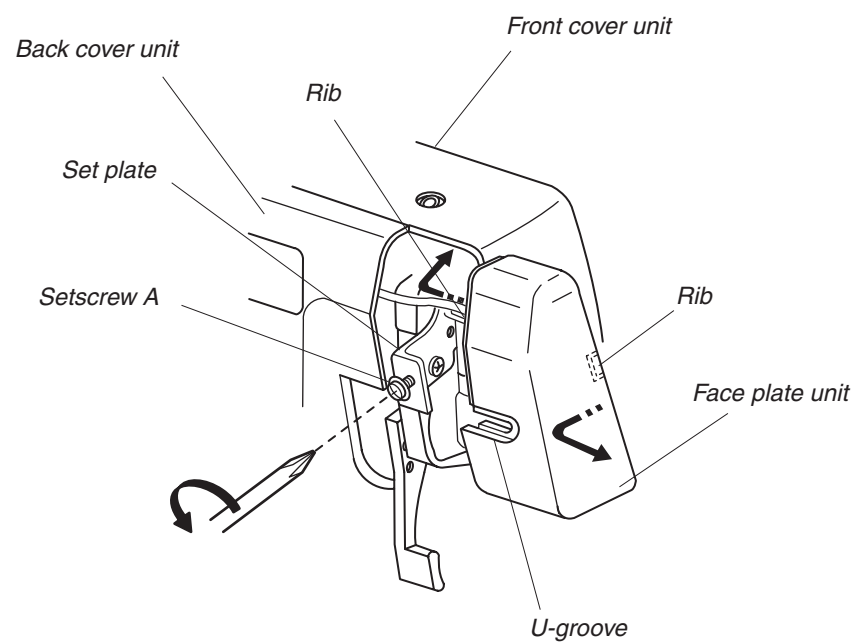

To remove:

1. Remove setscrews A and the spool stand.
2. Remove setscrews B, C and D
3. Remove the back cover unit.

To attach:

4. Put the ribs of back cover into the front cover unit and tighten setscrews B, C and D.
5. Attach the spool stand with setscrew A.

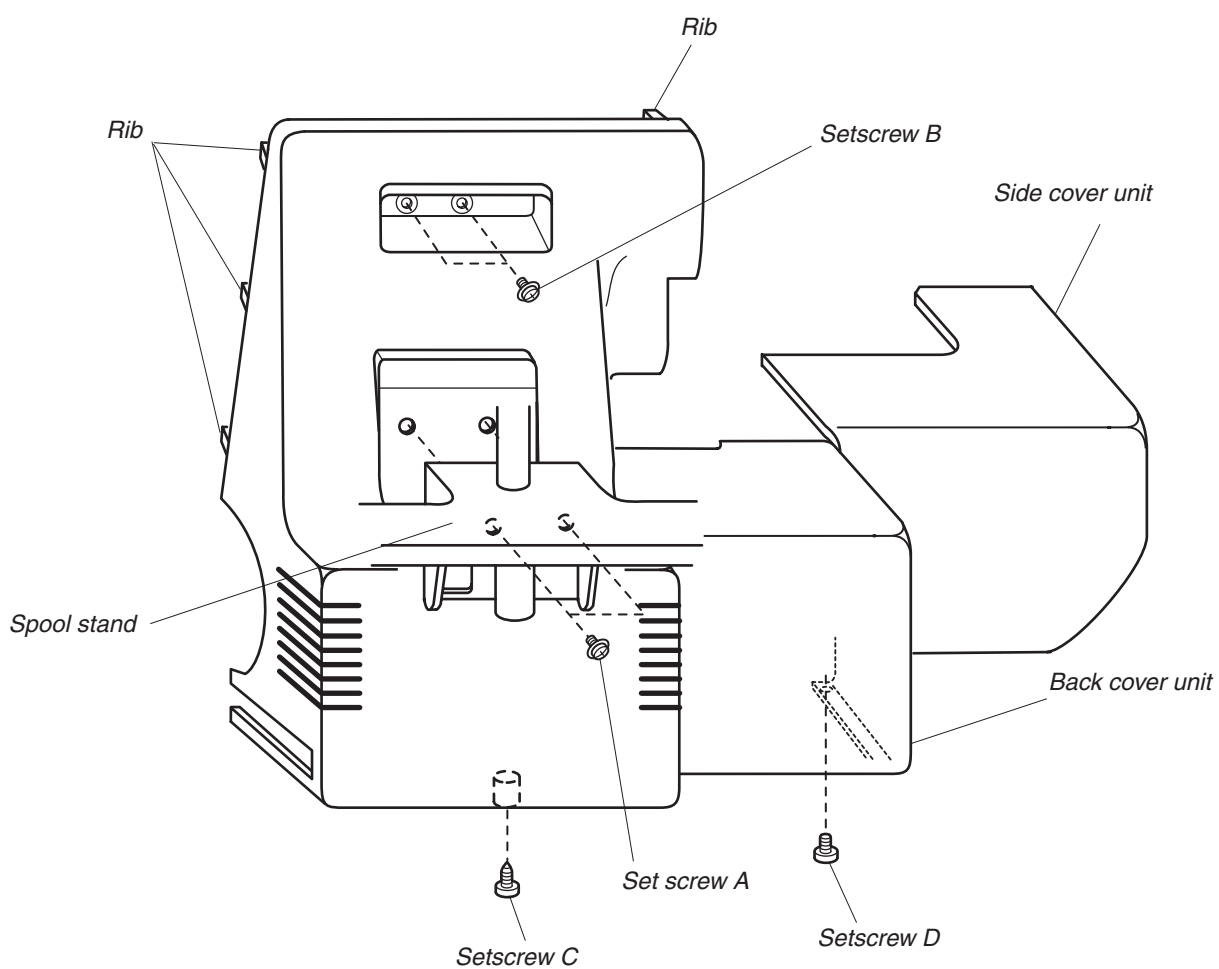

TO CHANGE THE TOP COVER

To remove:

1. Remove the back cover unit.
2. Loosen two setscrews A through hole of thread guide plate as illustration, and remove the top cover.

To attach:

3. Put the ribs in the front cover.
4. Tighten two setscrews A.

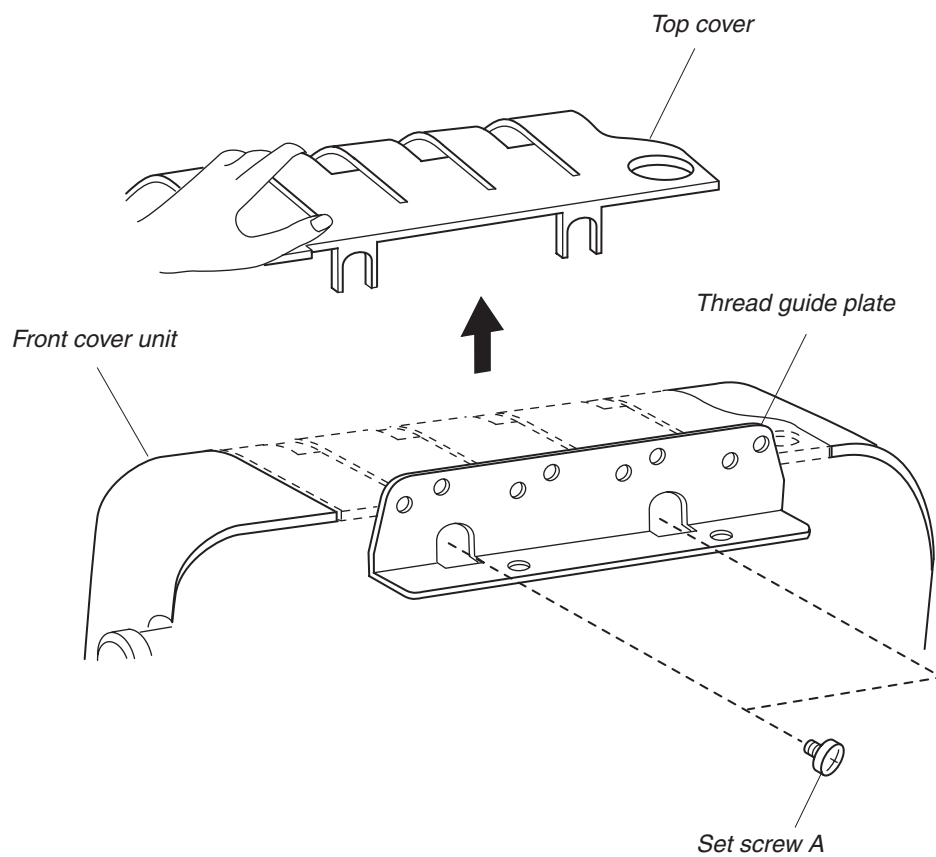

TO CHANGE THE FRONT COVER UNIT

To remove:

1. Remove setscrews A and the looper cover unit.
2. Remove the face plate unit, the back cover unit and top cover.
3. Turn the hand wheel toward you with your hand, and set the upper looper at its lowest position, and remove setscrews B, C, D, E and the front cover unit.

To attach:

4. Attach the front cover unit with setscrews B, C, D and E.
5. Attach the looper cover unit with setscrew A.
6. Attach the top cover, the back cover unit and face plate unit.

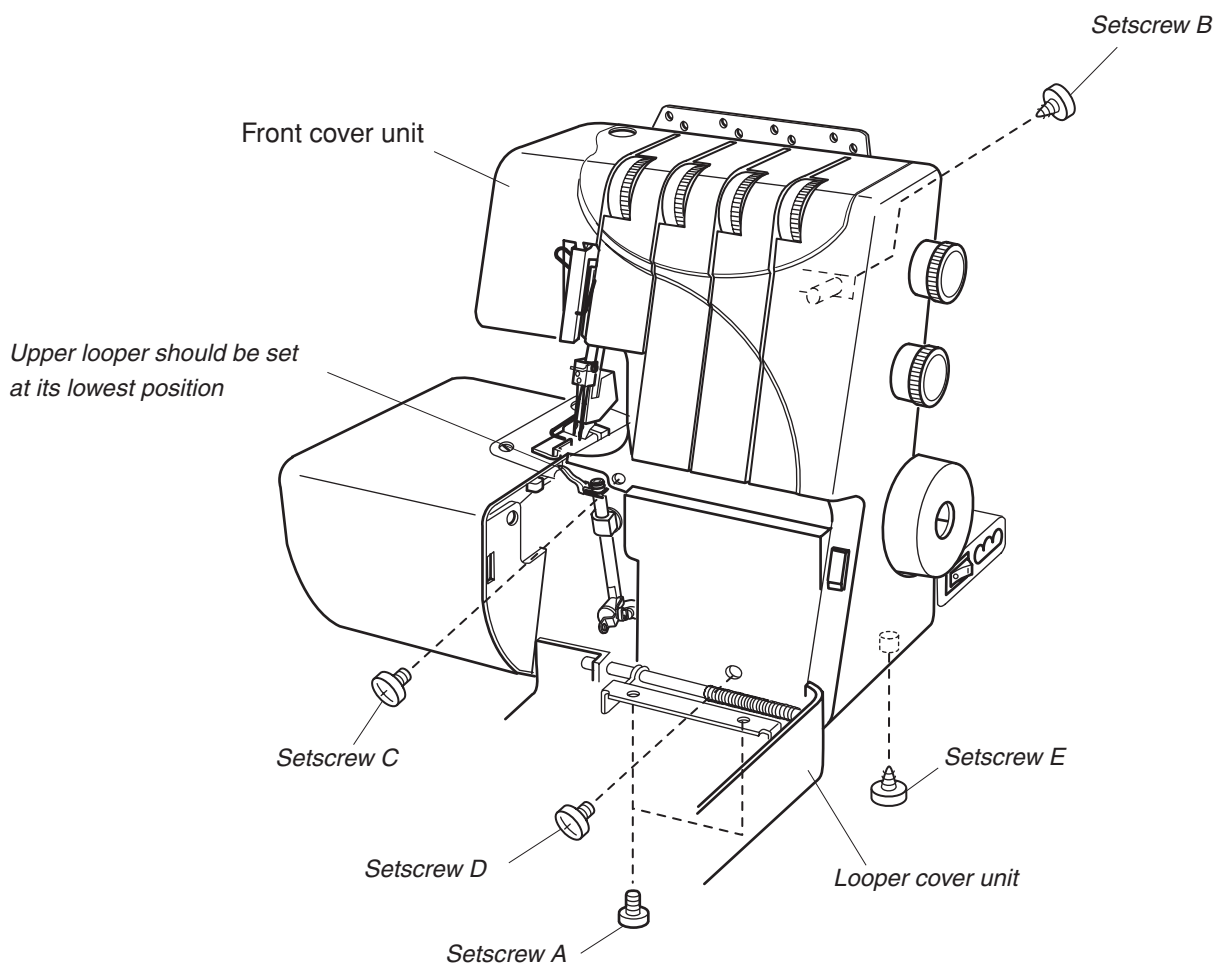

TO CHANGE THE SIDE COVER UNIT

To remove:

1. Open the side cover unit. Remove the snap ring E-3 and push down the shaft.

To attach:

2. Attach the side cover unit and insert the shaft and attach the snap ring.

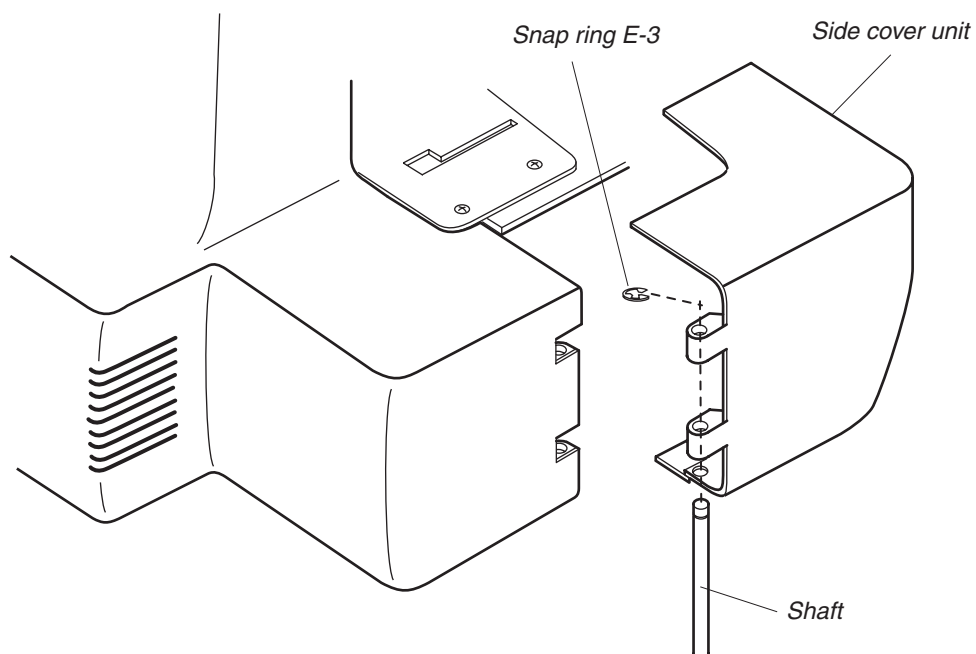

TO CHANGE THE MACHINE BASE

To remove:

1. Remove setscrews A, B, C, D and two hinge screws E, and remove two base cushions F and washers.
2. Remove the machine base.

NOTE: Do not remove another two base cushions.

To attach:

3. Attach the machine base unit, and tighten setscrews A, B, C and D.
4. Attach the two base cushions F, washers, and tighten hinge screws E.

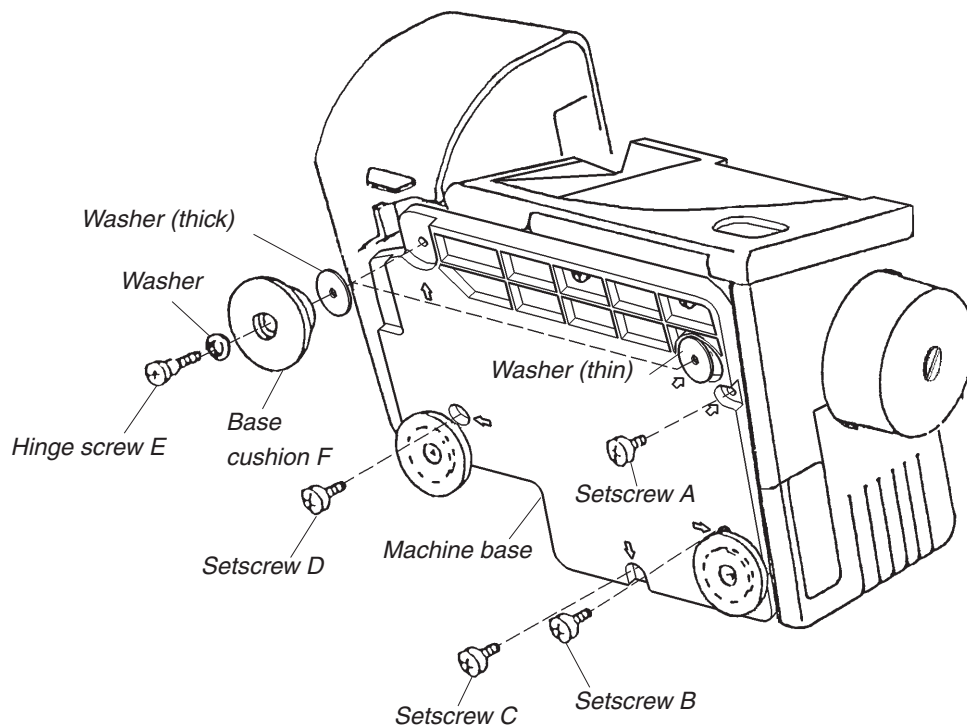

TO CHANGE THE MACHINE SOCKET

To remove:

1. Remove the back cover unit.
2. Remove setscrews (A, B) and the machine socket unit from the motor fixing plate.
3. Remove two setscrews C, and pull out the cord connectors.

To attach:

4. Insert the cord connectors as shown below.
5. Attach the machine socket, and tighten two setscrews C.
6. Attach the machine socket unit on the motor fixing plate and tighten setscrews (A, B).
7. Attach the back cover unit.

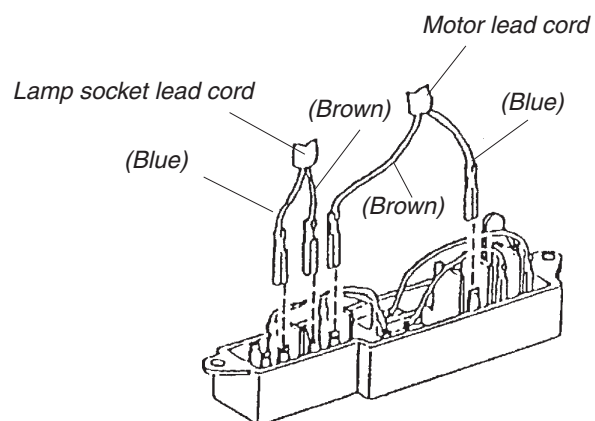
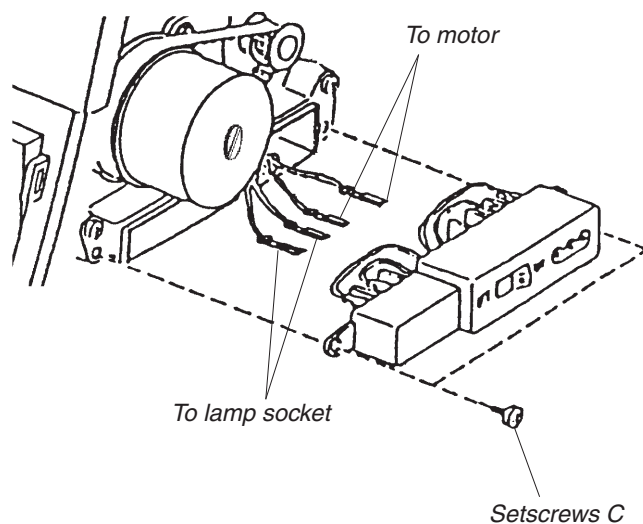

TO ADJUST THE NEEDLE HEIGHT

Correct Setting:

The distance between the tip of needle on the right and the surface of needle plate should be 11.6 to 12.2 mm when the needle bar is at the highest position.

To adjust:

1. Remove the looper cover unit, face plate unit, back cover unit, top cover and front cover unit.
2. Turn the handwheel toward you with your hand, and set the needle bar at the highest position.
3. Loosen setscrew A to adjust the height, and tighten setscrew A after the adjustment is done.
4. Turn the handwheel toward you one cycle, and recheck the needle bar height.
5. Attach the front cover unit, looper cover unit, top cover, back cover unit and face plate unit.

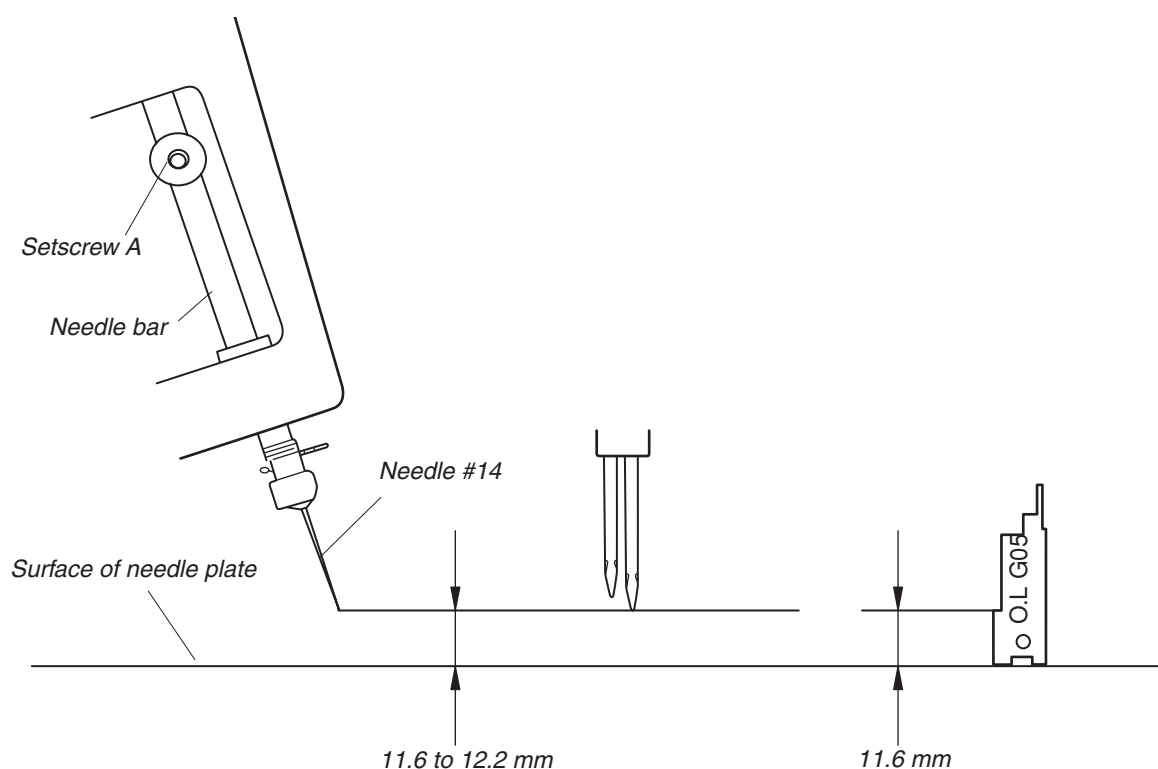

TO ADJUST THE PRESSER BAR HEIGHT

Correct Setting:

The distance between the surface of needle plate and bottom of presser foot should be 4.7 to 5.3 mm when the presser bar lifter is raised.

To adjust:

1. Remove the looper cover unit, face plate unit, back cover unit, top cover and front cover unit.
2. Raise the presser bar lifter and loosen setscrew A.
Then adjust the presser bar height, the side of presser foot should be parallel with the hole of needle plate.
3. Tighten the setscrew A.
4. Attach the front cover unit, looper cover unit, top cover, back cover unit and face plate unit.

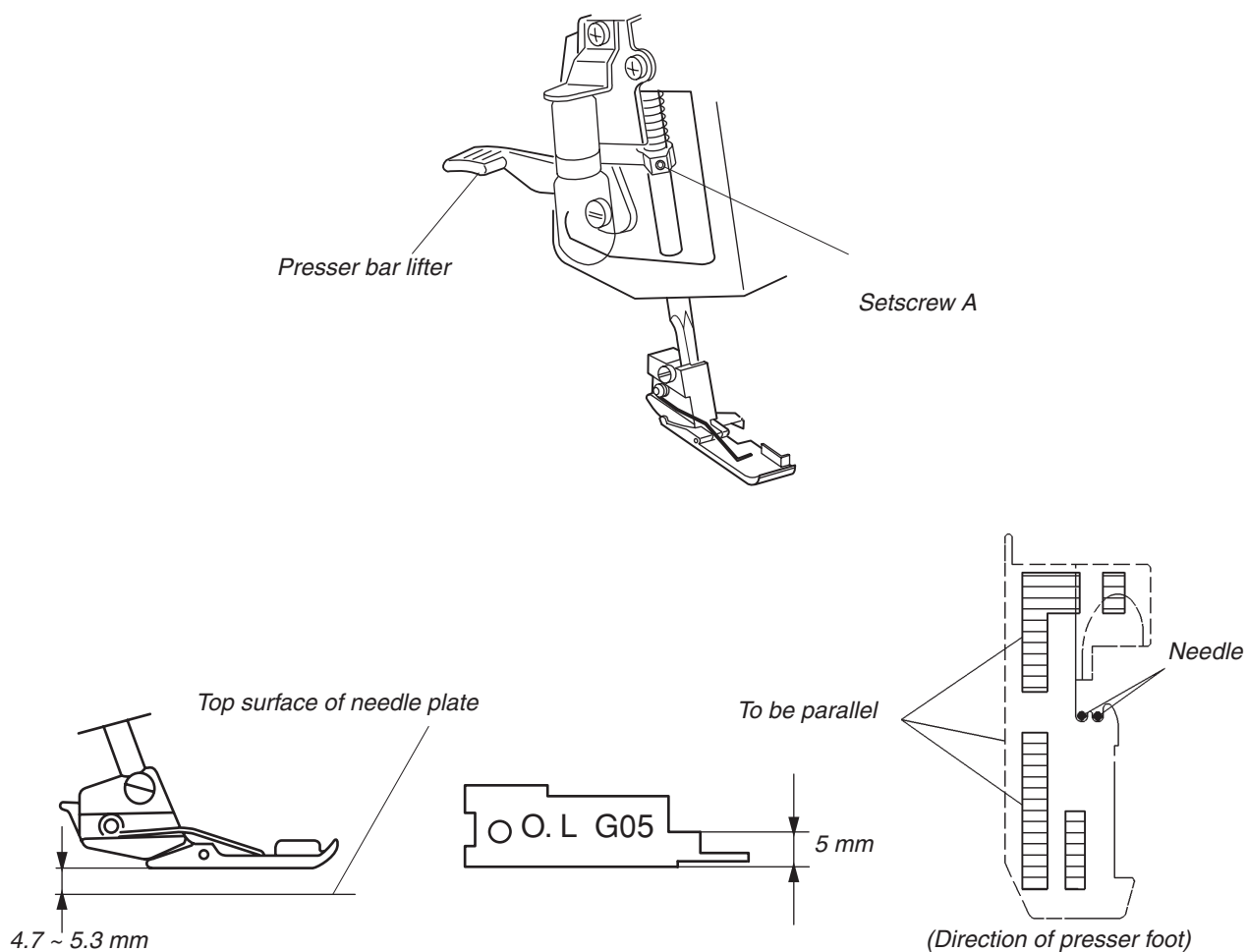

TO ADJUST THE FEED DOG HEIGHT

Correct Setting:

When the presser foot is lowered and feed dogs are at their highest position, the distance between the surface of needle plate and bottom of presser foot should be 0.75 to 0.95 mm.

To adjust:

1. Set the stitch length dial at “ 3 ” and the differential feed dial at “ 1.0 ”.
2. Remove the back cover unit.
3. Lower the presser foot and raise the feed dogs to their highest position by turning the handwheel.
4. Loosen the main & sub feed dog screws A, B (4 pcs.)
5. Push the main feed dog straight upward and adjust the distance between the surface of needle plate and bottom of presser foot, then tighten setscrews A (2 pcs.)
6. When the top of the main feed dog is level with the top surface of needle plate in its downward motion by turning the handwheel, push the sub feed dog straight upward until its top surface is to be level with the top surface of needle plate. Then tighten setscrews B of the sub feed dog.
7. Check if these feed dogs are attached in parallel to the surface of needle plate while turning the handwheel.
8. Attach the back cover unit.

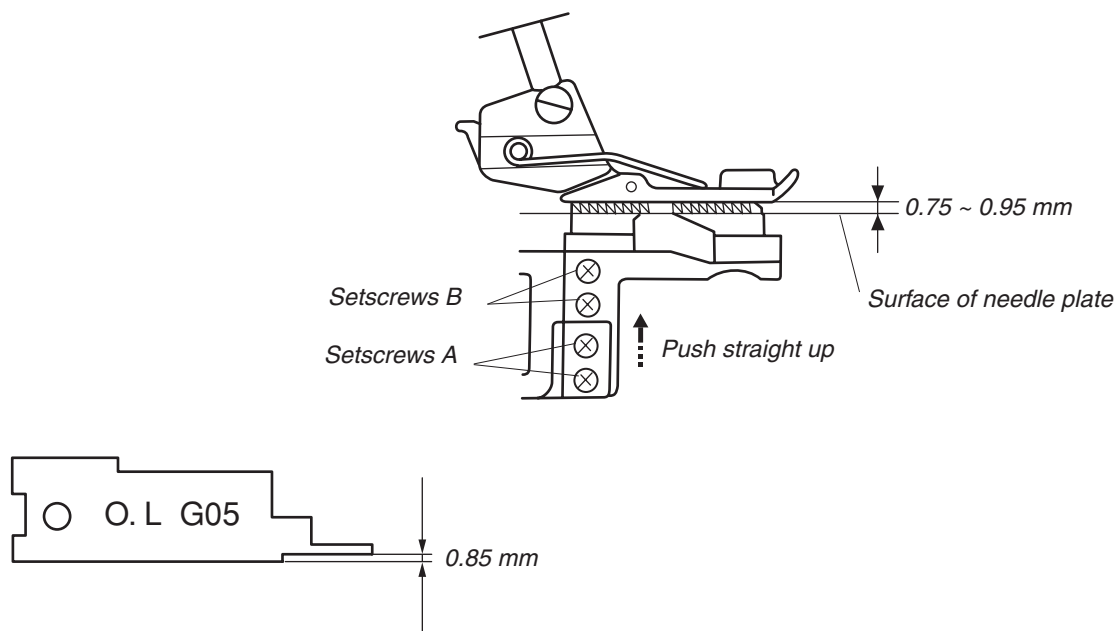

TO ADJUST THE TIMING OF THE NEEDLE AND THE FEED DOG

Correct Setting:

When the tip of right needle is at 2 to 4 mm above the needle plate in its downward motion, and presser foot lowered, the top of the feed dog teeth should be level with the top surface of needle plate at their rearmost position.

Before adjustment, check if the needle bar height and the feed dog height are correct.

To adjust:

1. Set the stitch length dial at “ 3 ” and differential feed dial at “ 1.0 ” .
2. Remove the back cover unit.
3. Raise the presser foot and move the tip of right needle at 3 mm above the needle plate in its downward motion by turning the handwheel.
4. Lower the presser foot, and loose two setscrews A for main feed cam, two setscrews B for sub feed cam, and adjust the position of the sub feed cam and tighten setscrews B.
 - # Turn the sub feed cam to the direction C if the feed dog is lower than the surface of the needle plate.
 - # Turn the sub feed cam to the direction D if the feed dog is higher than the surface of the needle plate.
5. Set the main feed cam to keep the clearance between the bushing and main feed cam to about 1 mm, and tighten two setscrews A.
6. Attach the back cover unit.

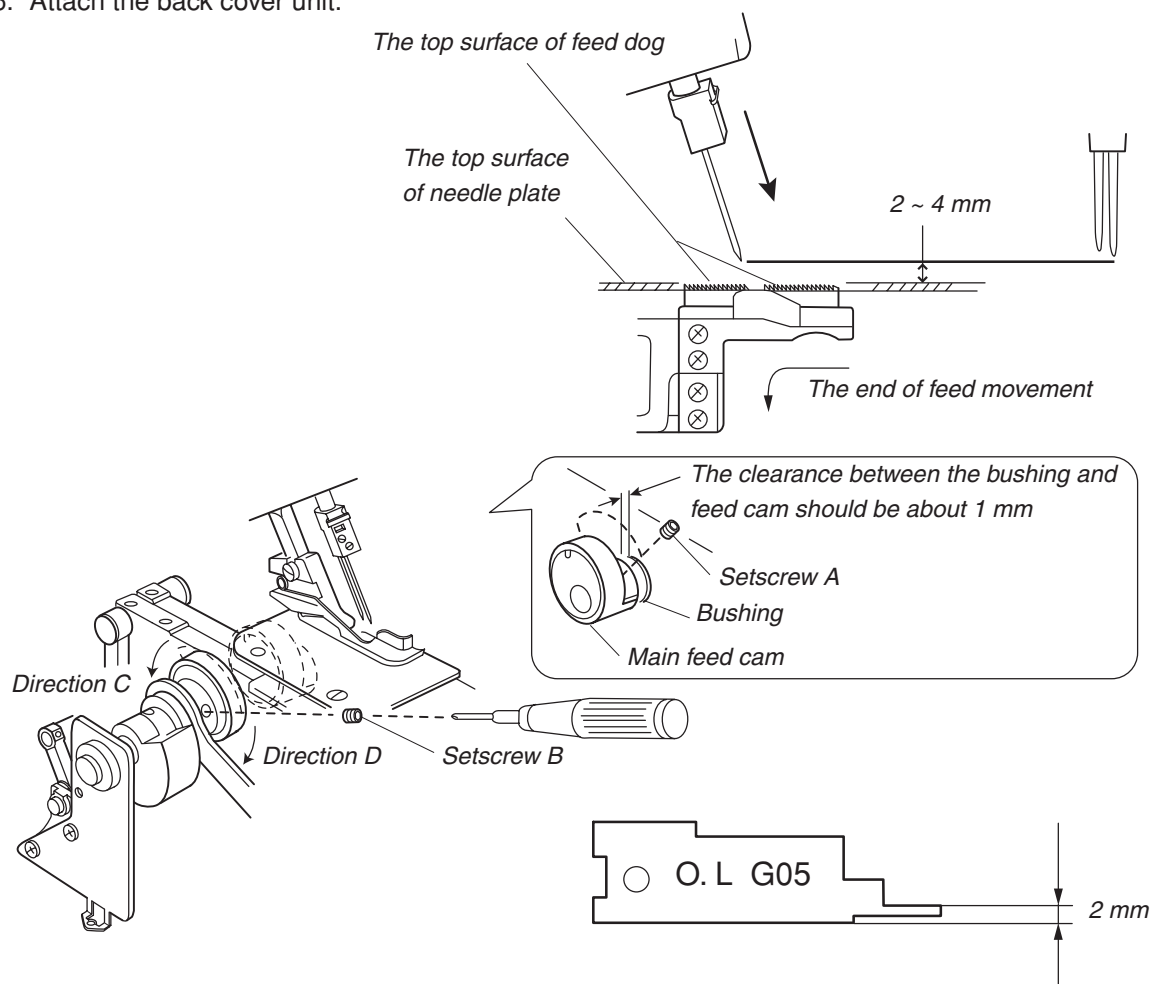

TO ADJUST THE TIMING OF THE NEEDLE AND THE UPPER KNIFE

Correct Setting:

The upper knife timing is the same as that of the needle bar. In fact, when the needle bar is at highest position, the upper knife should be also at its highest position.

To adjust:

1. Remove the back cover unit.
2. Loosen two setscrews A, and move the balance weight to left.
3. Loosen two setscrews B, and adjust the needle and upper knife timing.
 - # Turn the upper knife drive cam to the direction C when the upper knife timing is being delay.
 - # Turn the upper knife drive cam to the direction D when the upper knife timing is too soon.
4. Tighten two setscrews B firmly. Move the balance weight to right.
Match the guide line on the balance weight with the one of the main shaft correctly.
Then tighten the two screws A.
5. Turn the handwheel toward you one cycle, and recheck the needle and the upper knife timing.
6. Attach the back cover unit.

*When the needle bar goes up,
the upper knife goes up.*

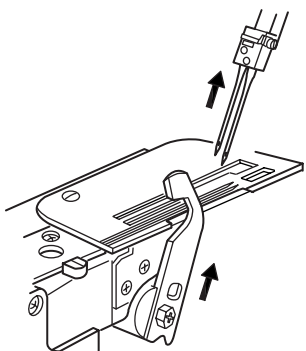

*When the needle bar goes down,
the upper knife also goes down.*

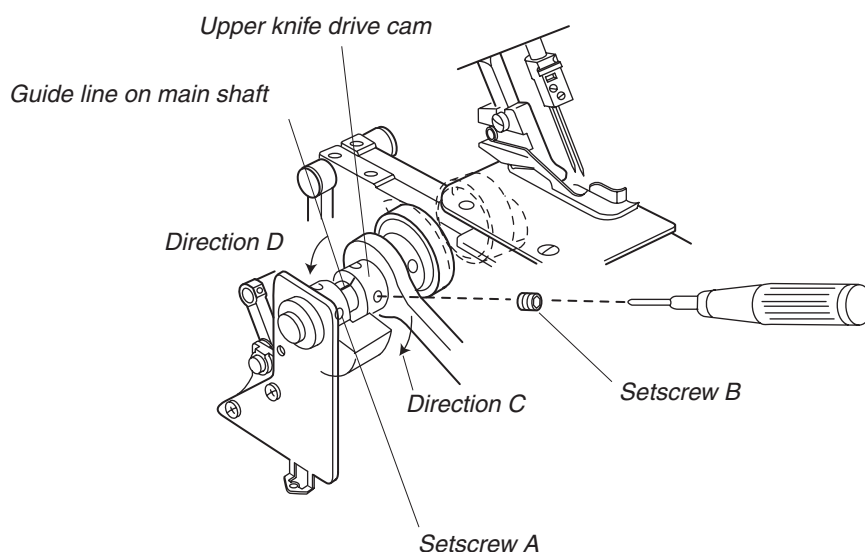
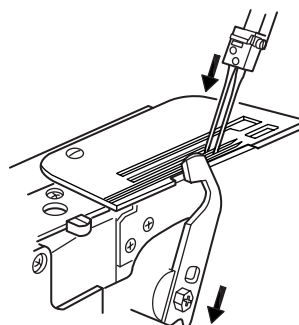

TO ADJUST THE HEIGHT OF THE LOWER LOOPER

Correct Setting:

The height of lower looper is 65.7 mm from center of lower looper shaft as shown in Illustration.

To adjust:

1. Set the upper knife in down position to loosen setscrew A.
2. Turn the handwheel to get the lower looper in rightmost position.
3. Replace the lower looper.
4. Turn the handwheel to get the lower looper in leftmost position.
5. Insert the gauge downwards into the lower looper shaft as shown.

NOTE: If the clearance between the lower looper unit and the lower looper thread guide is too close, remove the lower looper thread guide.

After the adjustment, attach the lower looper thread guide on the lower looper shaft as shown.

6. Loosen setscrew A , and move the lower looper up or down to get the tip of lower looper is in line with guide line of gauge.
7. Tighten setscrew A.
8. Remove the gauge and set the upper knife in up position.

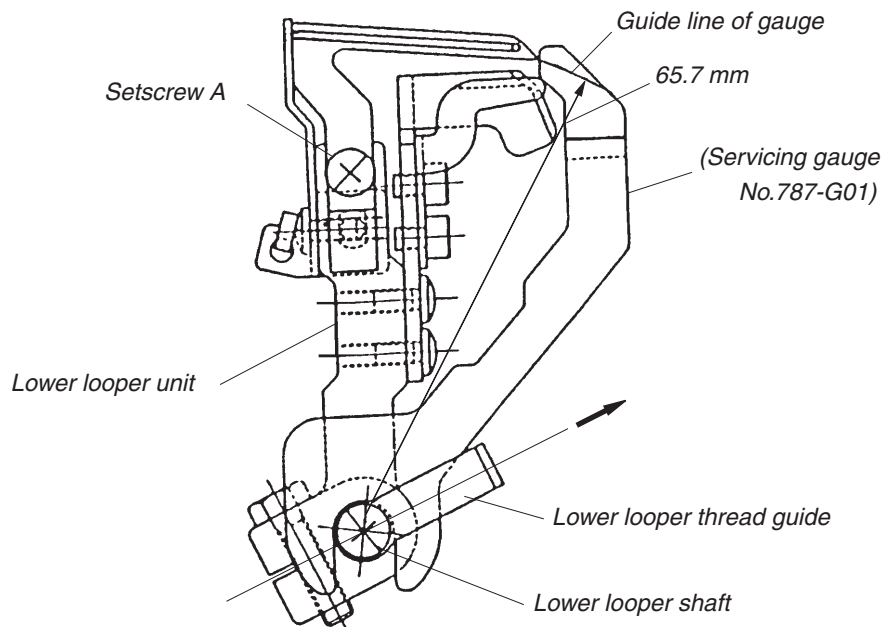

TO ADJUST THE CLEARANCE BETWEEN THE NEEDLES AND THE LOWER LOOPER/NEEDLE GUARDS (1 of 3)

Correct Setting:

Both right and left needles should have an equal clearance from the front edge of the needle holes on the needle plate.

The standard clearance between the left and right needle and the tip of the lower looper is 0 mm to 0.05 mm.

The standard clearance between the needle and the rear needle guard is 0 mm to 0.2 mm.

The above standard clearance allows the needle to slightly touch the front needle guard.

To adjust:

1. Remove the looper cover unit, face plate unit, back cover unit, top cover, front cover unit, presser foot and needles.
2. Before loosening setscrew C, attach the needle gauge #787-G02 to prevent change of needle bar height during the adjustment.
3. Attach two #11 needles on the needle clamp and loosen setscrew C. Adjust the two needles, to make the clearance between both needles and the front edge of the needle hole of the needle plate equal by turning the needle bar in the D or E direction while pushing up the needle bar to prevent change of needle bar height.
4. Retighten setscrew C and remove the needle gauge.

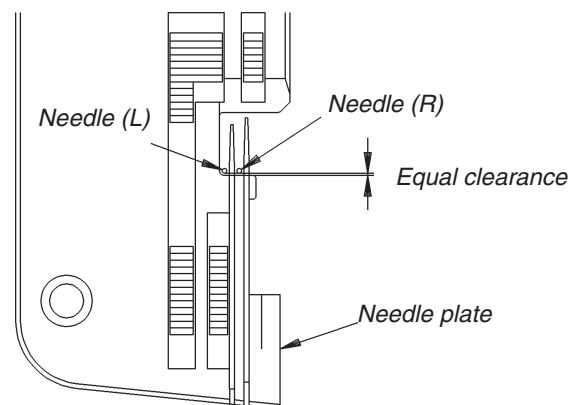
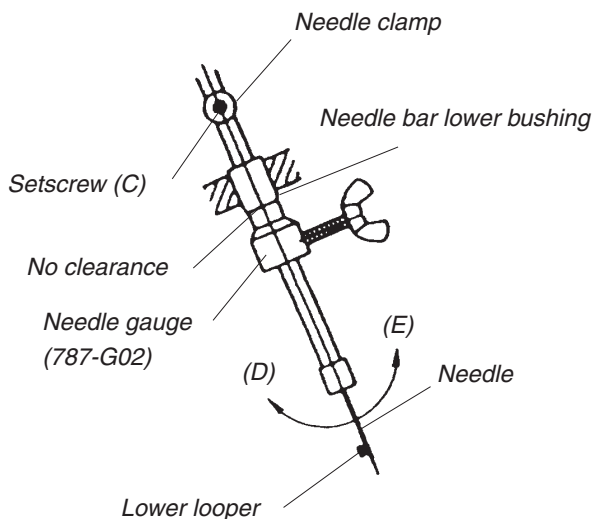

TO ADJUST THE CLEARANCE BETWEEN THE NEEDLES AND THE LOWER LOOPER/NEEDLE GUARDS (2 of 3)

1. Remove the left needle only.
2. Turn the handwheel towards you to bring the tip of the lower looper from the left hand to the rear side of the right needle.
3. Loosen the hexagonal socket screws A on the front needle guard and open a space between the front needle guard and the needle.
4. Next, loosen the hexagonal bolt B, and slide the lower looper unit to the front or to the back to adjust the clearance between the right needle and the tip of the lower looper.
The clearance should be 0 mm to 0.05 mm.
5. Retighten the hexagonal bolt B.

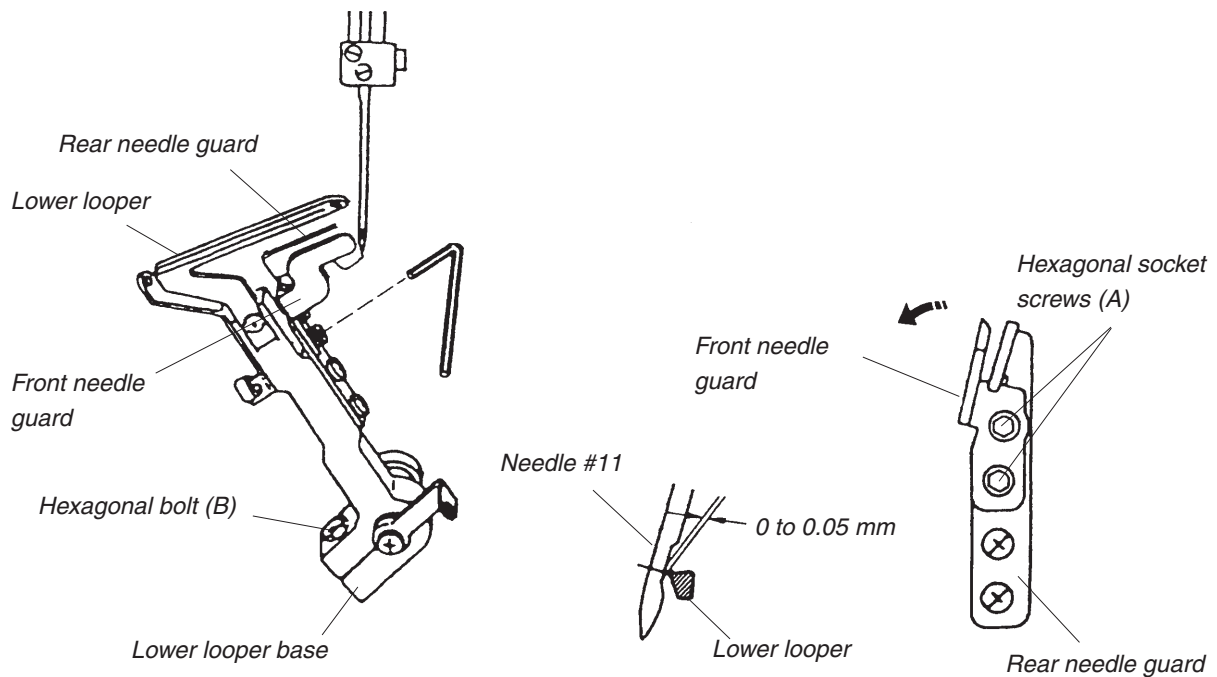

TO ADJUST THE CLEARANCE BETWEEN THE NEEDLES AND THE LOWER LOOPER/NEEDLE GUARDS (3 of 3)

1. Change the right needle from #11 to #14.
2. Push the right needle by the front needle guard to adjust the clearance between the needle and the tip of the lower looper. The clearance should be 0 mm to 0.05 mm.
3. Attach #14 needle on the left needle position and turn the handwheel towards you to check the clearance between the left needle and the tip of the lower looper.
Make sure the front needle guard is touching the needle slightly and the rear needle guard is not touching the needle.
4. Check the timing between the needle and the lower looper.
5. Recheck the needle bar height and the clearance between the needle and the lower looper.

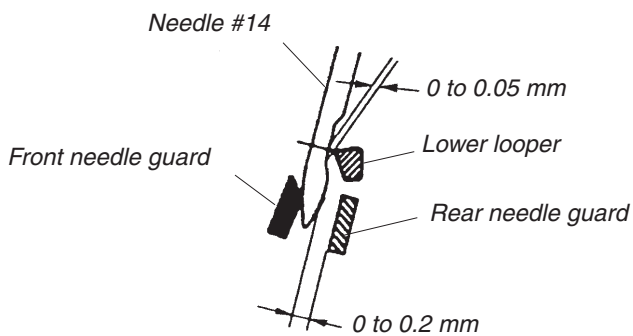

(Rear needle guard is not touching the needle.)

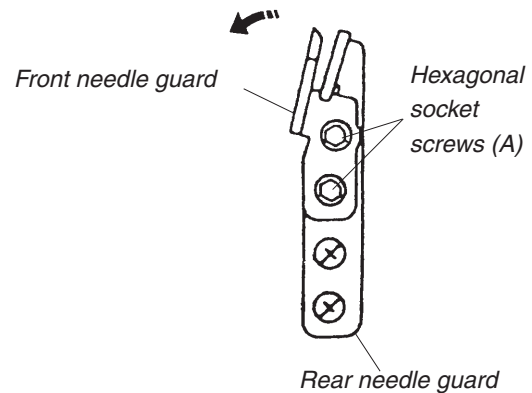

TO ADJUST THE CLEARANCE BETWEEN THE NEEDLES AND THE FIXED NEEDLE GUARD

Correct Setting:

The clearance between needle and the fixed needle guard should be 0.1 to 0.4 mm.

To adjust:

1. Remove the presser foot and the needle plate and lower the needle to its lowest position.
2. Loosen setscrew A and adjust the position of the fixed needle guard.
3. Tighten setscrew A.
4. Attach the needle plate and the presser foot.

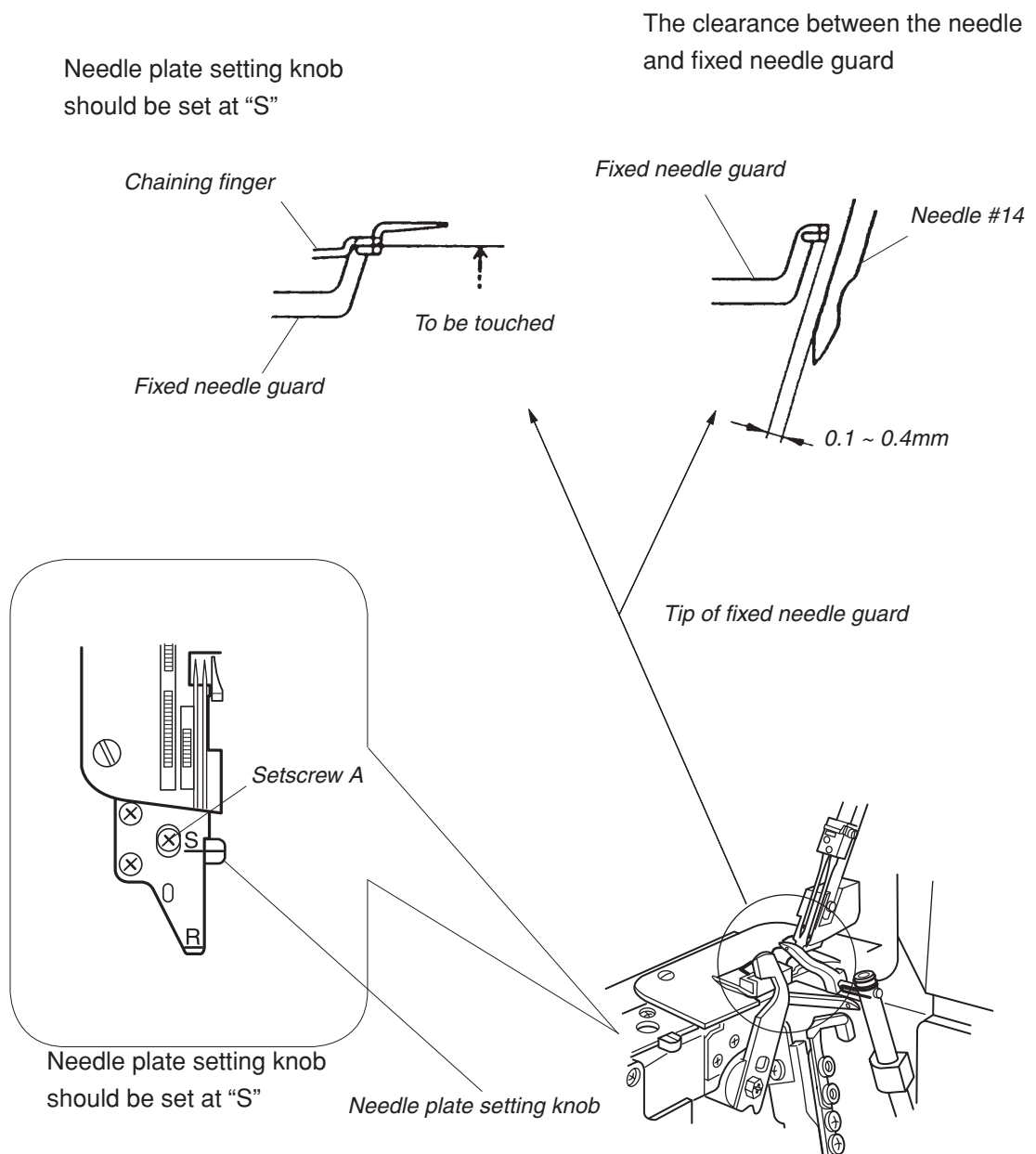

TO ADJUST THE POSITION OF THE CHAINING FINGER

Correct Setting:

When set the needle plate setting knob to the guide line S, the chaining finger should touch the side of needle plate, and the tip of chaining finger should be same level with the tip of the needle on the needle plate.

To adjust:

1. Remove the presser foot.
2. Set the needle plate setting knob to the guide line S on the chaining finger unit.
3. Loosen two setscrew A, and move the chaining finger unit to correct position.
4. Tighten two setscrew A.
5. Set the needle plate setting knob to the guide line S and R, and check the position of chaining finger.
6. Attach the presser foot.

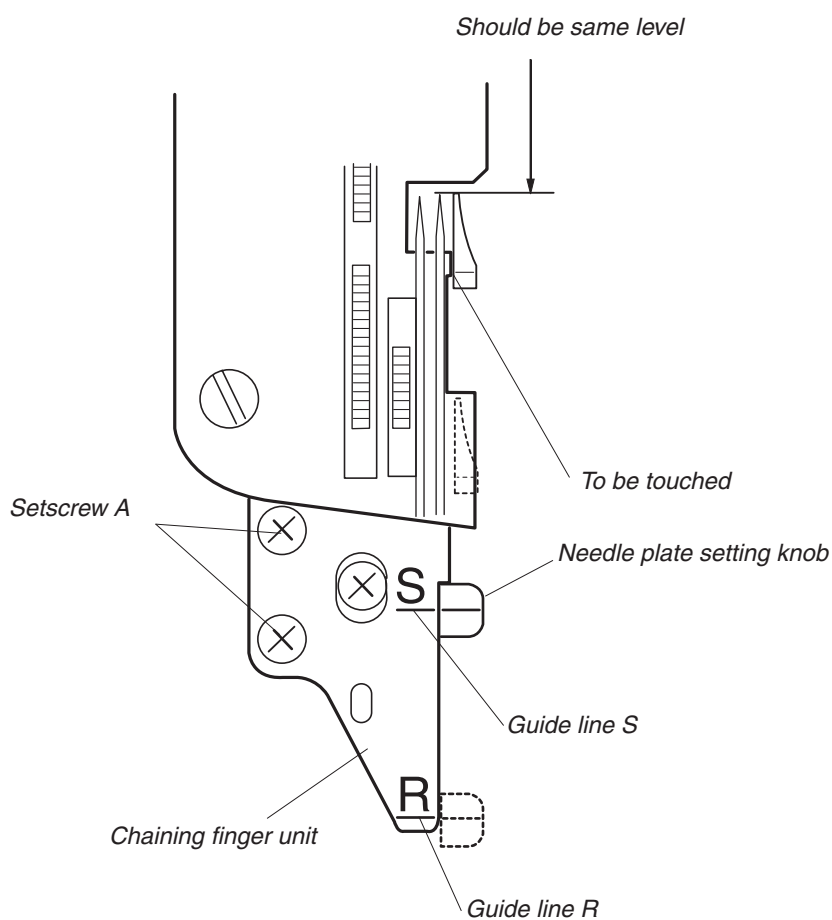

TO ADJUST THE POSITION OF THE UPPER LOOPER

Correct Setting:

When the upper looper is at the leftmost position, the distance between the center of needle on the right and the center of looper eye should be 4.8 to 5.2 mm.

To adjust:

1. Remove the machine base.
2. Loosen the hexagonal socket screws A, and adjust the distance between upper looper shaft guide and bottom of upper looper. The distance should be 1.6 to 1.8 mm when the upper looper is at the lowest position as shown in Fig. 1.
3. Tighten the hexagonal socket screws A.
4. Turn the handwheel and bring the upper looper to the leftmost position.
5. Loosen the hexagonal socket screw B, and adjust the distance between the center of needle and center of upper looper eye as shown in Fig. 2 and Fig. 3.
6. Tighten the hexagonal socket screw B.
7. Check the upper and lower loopers timing and the clearance between upper and lower loopers.

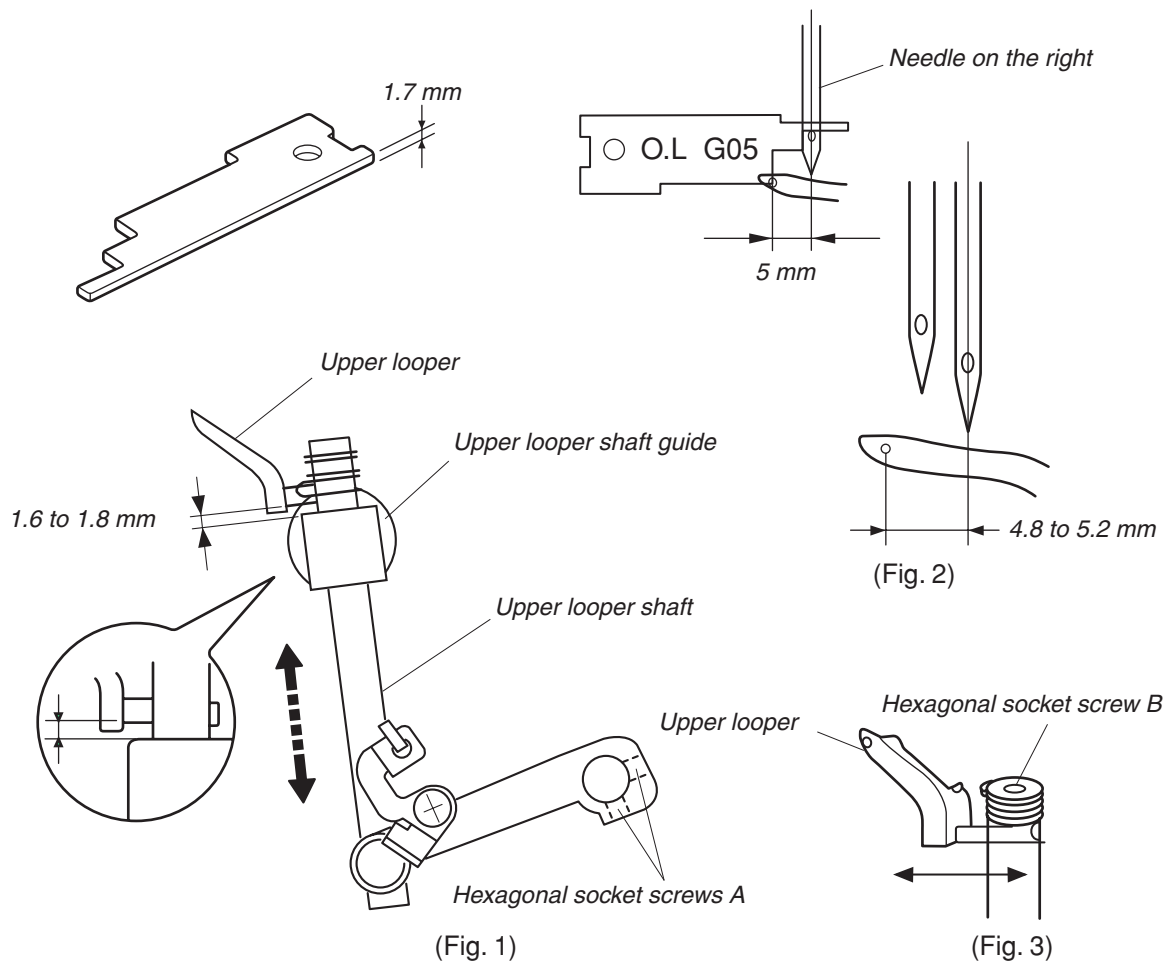

TO ADJUST THE TIMING OF THE NEEDLE AND THE LOWER LOOPER

Correct Setting:

When the needle comes up 2.8 to 3.2 mm (7/64 to 1/8") from its lowest position, the tip of the lower looper comes just left of the needle (#11) on the right.

To adjust:

1. Remove the presser foot, needle plate and left-side needle.
2. Replace right-side needle with a #11 one.
3. Turn the handwheel toward you to get the lowest needle position.
4. Set the two gauges (787-G02, 787-G03), as shown in (Fig. 1) and tighten bolt (B).
This time, there should be no clearance between the gauges and the needle bar lower bushing.
5. Remove plate gauge (787 - G03). Then turn the handwheel toward you until it touches the needle bar lower bushing, as shown in (Fig. 2).
6. In this condition, loosen the hexagonal bolt (C) just enough to move the lower looper base.
Adjust the lower looper position in order to meet the tip of lower looper with left-side of needle (#11), as shown in (Fig. 3) and (Fig. 4).
Tighten hexagonal bolt (C).
7. Remove the gauge (787 - G02).
Check the clearance between the needle and lower looper.
Check the clearance between the loopers.
8. Replace the right side needle with a #14 one.
9. Attach the left side needle, needle plate and presser foot.
Be careful not to tighten bolt (B) too much.

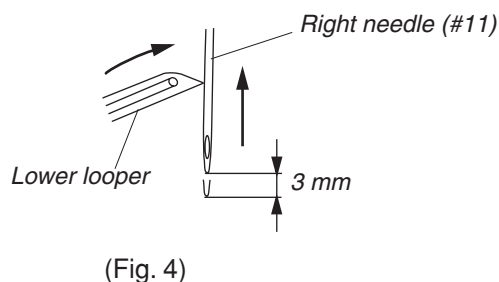
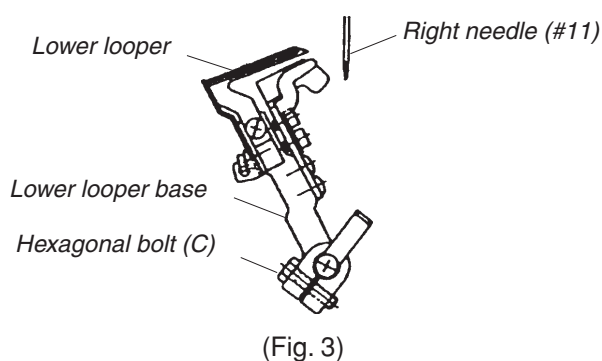
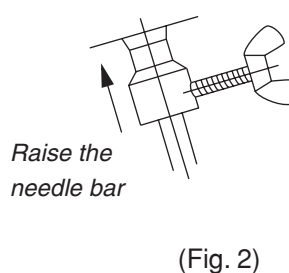
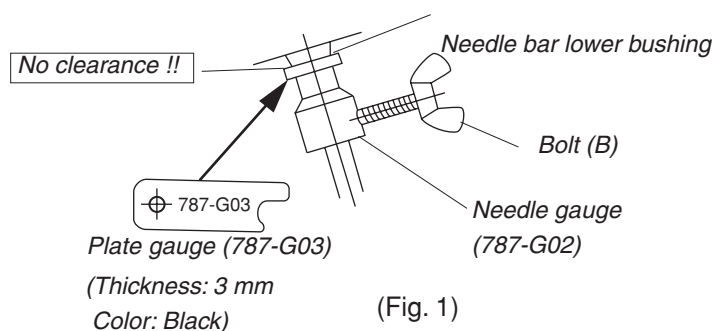

TO ADJUST THE TIMING OF THE UPPER AND LOWER LOOPERS

Correct Setting:

When the lower looper moves to the right, the tip of upper looper meets the lower looper within 0.2 to 1.2 mm from the left of lower looper eye as shown in Fig. 1.

To adjust:

1. Before proceeding with this adjustment, check the lower looper timing and position of upper looper.
2. Remove the machine base.
3. Loosen two setscrews, and adjust the timing by turning the upper looper drive cam in the direction of:
A if the timing of upper looper is advanced as shown in Fig. 3.
B if the timing of upper looper is delayed as shown in Fig. 4.
The allowance is 0.2 to 1.2 mm from the left edge of lower looper eye as shown in Fig. 1.
4. Tighten two setscrews.
5. Check the clearance between the loopers.
6. Attach the machine base.

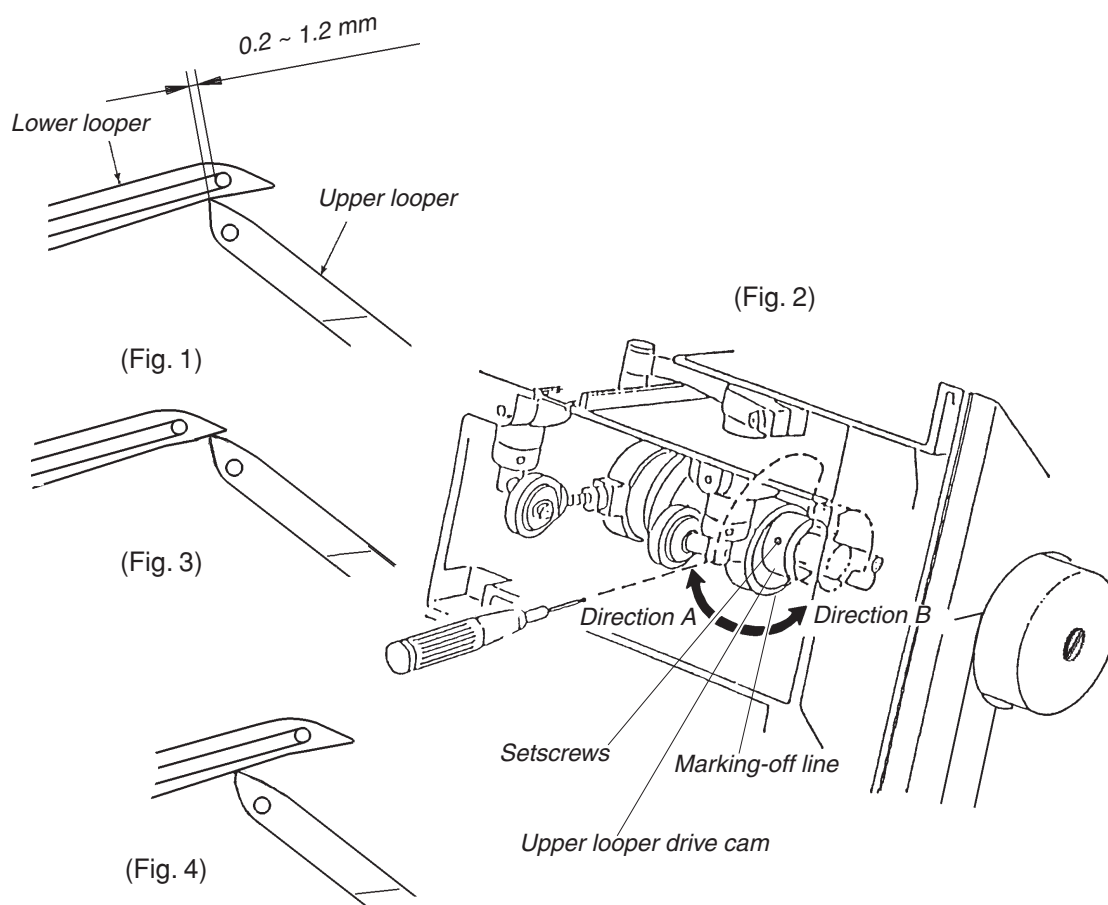

TO ADJUST THE CLEARANCE BETWEEN THE LOOPERS

Correct Setting:

When the loopers meet as shown in Fig. 2, the clearance should be 0 to 0.1 mm as shown in Fig. 1.

To adjust:

1. Remove the presser foot and needle plate.
2. Turn the handwheel toward you with your hand to bring the loopers as shown in Fig. 2.
3. Loosen setscrew, and adjust the clearance by moving the upper looper to the back or front as shown in Fig. 3.
4. Tighten the setscrew firmly.
5. Check the clearance between the upper looper and needle.
6. Attach the needle plate and presser foot.

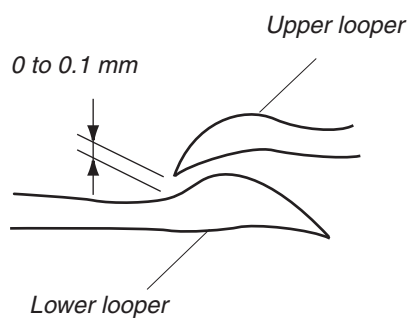

(Fig. 1)

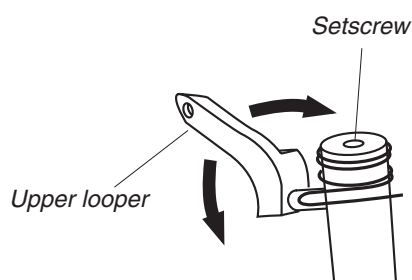

(Fig. 3)

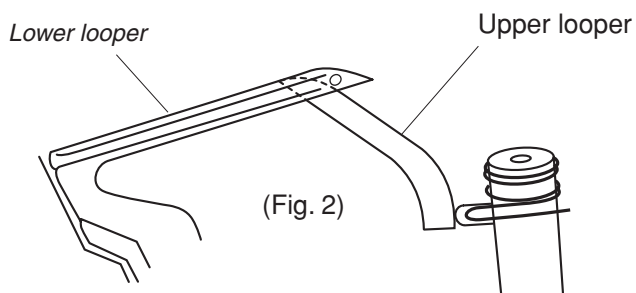

(Fig. 2)

TO ADJUST THE CLEARANCE BETWEEN THE NEEDLE AND THE UPPER LOOPER

Correct Setting:

When the upper looper meets with needle, the clearance should be:

0 to + 0.1 mm at the needle on the left.

-0.05 to + 0.05 mm at the needle on the right.

To adjust:

1. Turn the handwheel toward you with your hand to bring the needle just behind the upper looper in downward travel.
2. Loosen the setscrew, and adjust the clearance between the both needles and upper looper.
3. Tighten the setscrew.
4. Check the clearance between the loopers.

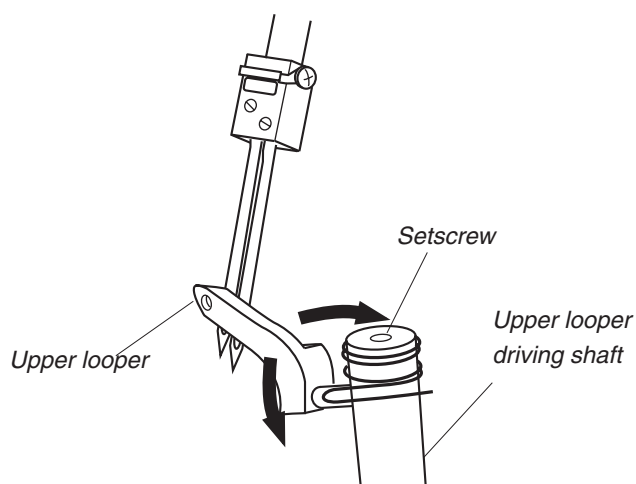
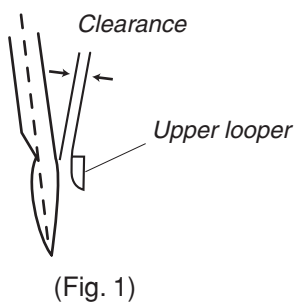

TO ADJUST THE POSITION OF THE KNIVES

Correct Setting:

The tip of the lower knife should be leveled with the surface of needle plate. When the upper knife is at the lowest position, the front lower corner of upper knife should be 0.8 to 1.5 mm below the edge of lower knife.

To adjust:

1. Before proceeding with this adjustment, check the upper knife timing.
2. Loosen the two setscrews A, and adjust the lower knife position.
3. Turn the handwheel to bring upper knife to the lowest position.
4. Loosen the hexagonal bolt B, and adjust the position of upper knife.
5. Tighten the hexagonal bolt B.

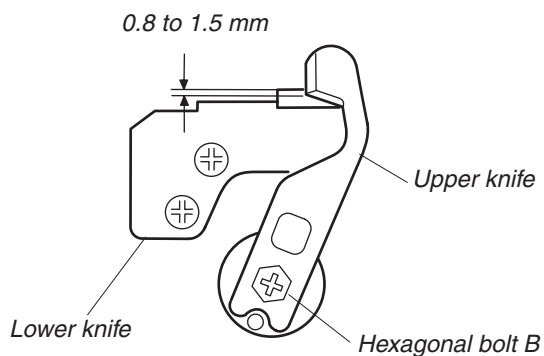
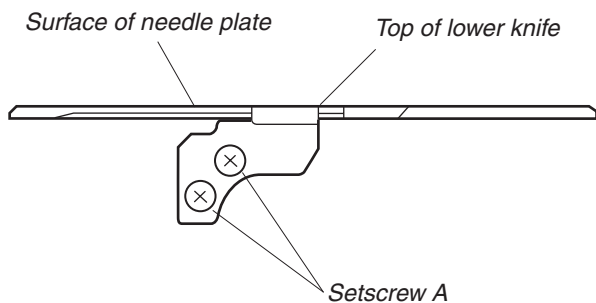
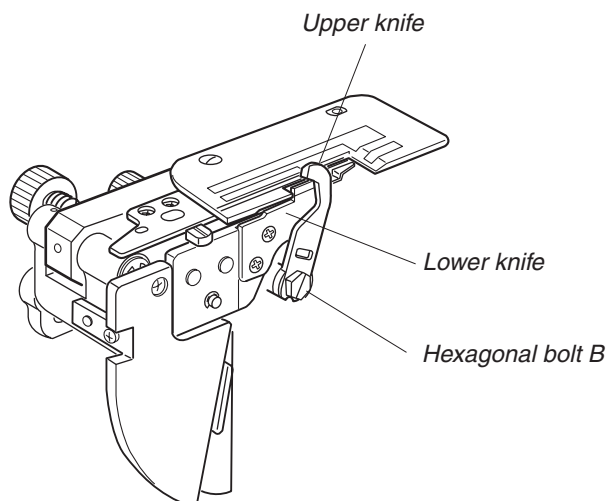

TO ADJUST THE POSITION OF THE LOWER LOOPER THREAD GUIDE

Lower Looper Thread Guide (4)

Loosen setscrew A, and adjust the lower looper thread guide (4) so that the hold of thread guide is in line with the groove of lower looper as shown in Fig. 1.

NOTE: After adjustment, check that lower looper thread guide (4) should not touch the arm and feed dog.

Looper Thread take-up lever

Loosen setscrew C, and the bottom side of the looper thread take-up lever is in line with the bottom side of the upper looper waving arm.

Tighten setscrew C to secure the position.

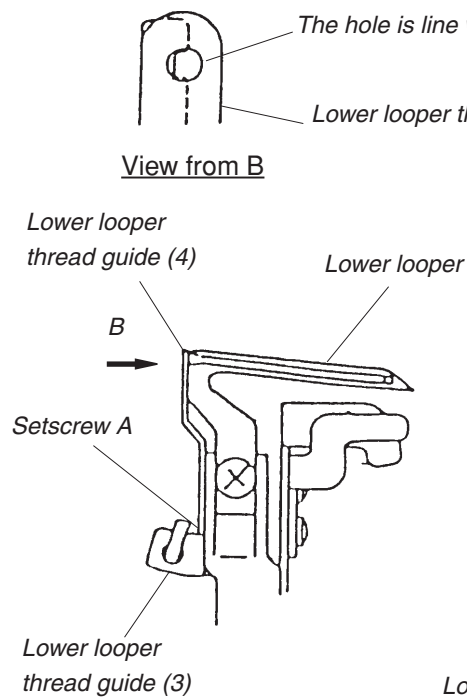

(Fig. 1)

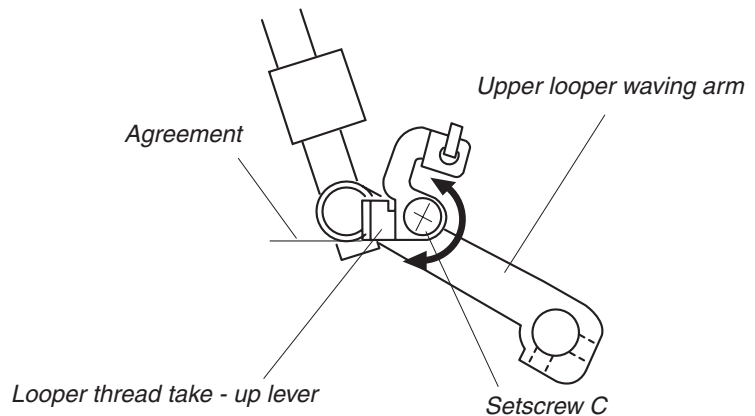

(Fig. 2)

TO ADJUST THE STITCH LENGTH

Correct Setting:

The actual stitch length should be 2.8 to 3.0 mm when the stitch length dial is set at “ 3 ” and the differential feed dial at “ 1.0 ”.

To adjust:

1. Set the stitch length dial at “ 3 ” and the differential feed dial at “ 1.0 ”.
2. Remove the looper cover unit, face plate unit, back cover unit, top cover and front cover unit.
3. If the actual stitch length is longer than 3.0 mm, turn the adjusting screw in the direction A.
If the actual stitch length is smaller than 2.8 mm, turn the adjusting screw in the direction B.
4. Attach the front cover unit, looper cover unit, top cover, back cover unit and face plate unit.

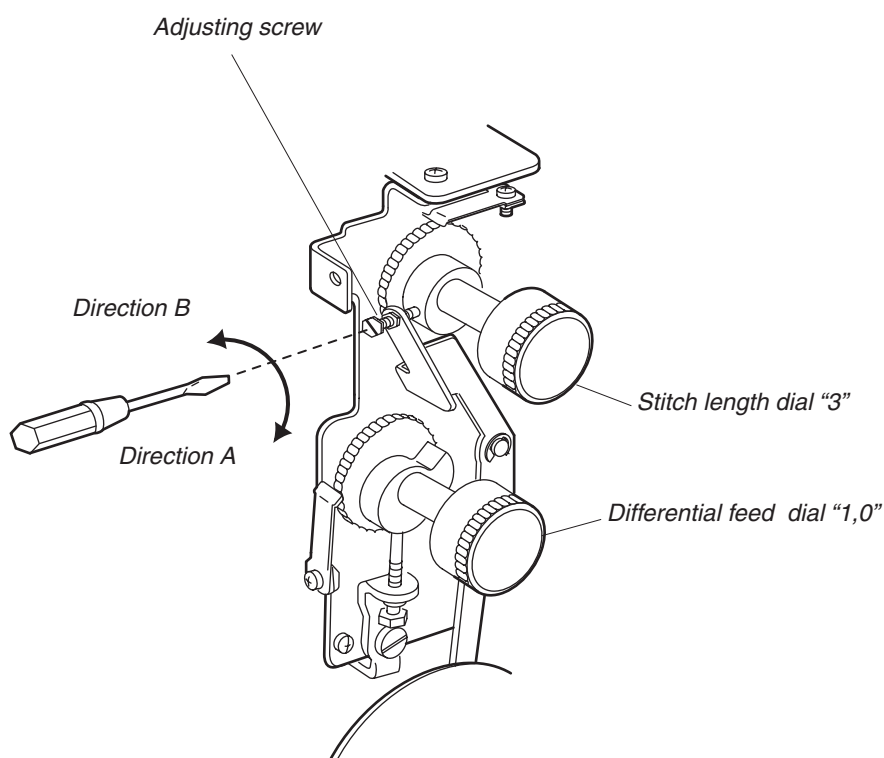

TO ADJUST THE THREAD TENSION DIALS

To check:

Thread tension dials are already adjusted for general sewing at factory, however, if you want to adjust much stronger or weaker special sewing, it can be adjusted as follow:

Adjustment procedure:

1. Remove the back cover and the top cover.
2. Adjust each thread tension with the adjusting plate A.
 - * If the thread tension is at stronger level, shift the adjusting plate in the direction B.
 - * If the thread tension is at weaker level, shift the adjusting plate in the direction C.
3. Rotate the thread tension dial while sewing to check the sewing performance.
4. Attach the top cover and the back cover.

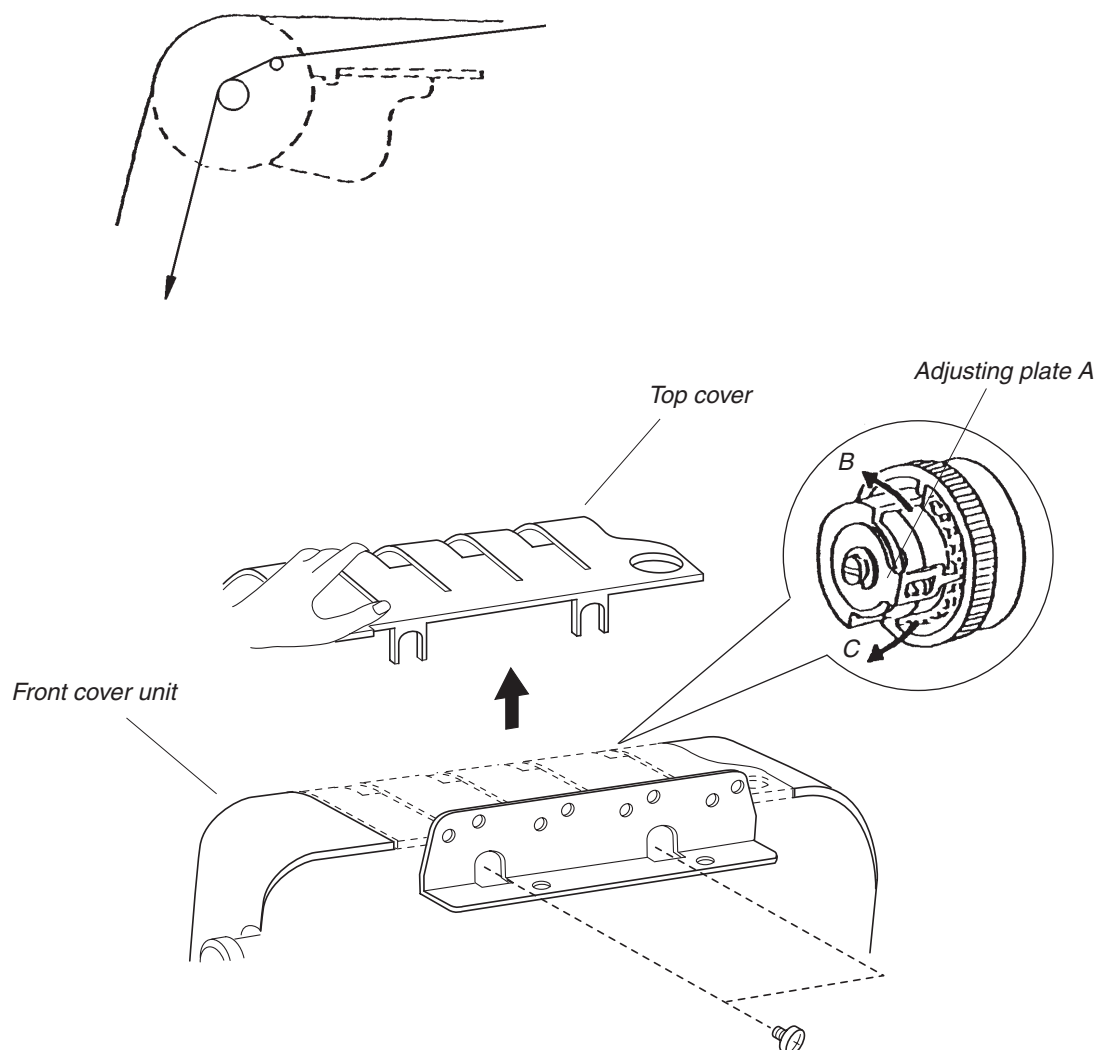

PARTS LIST

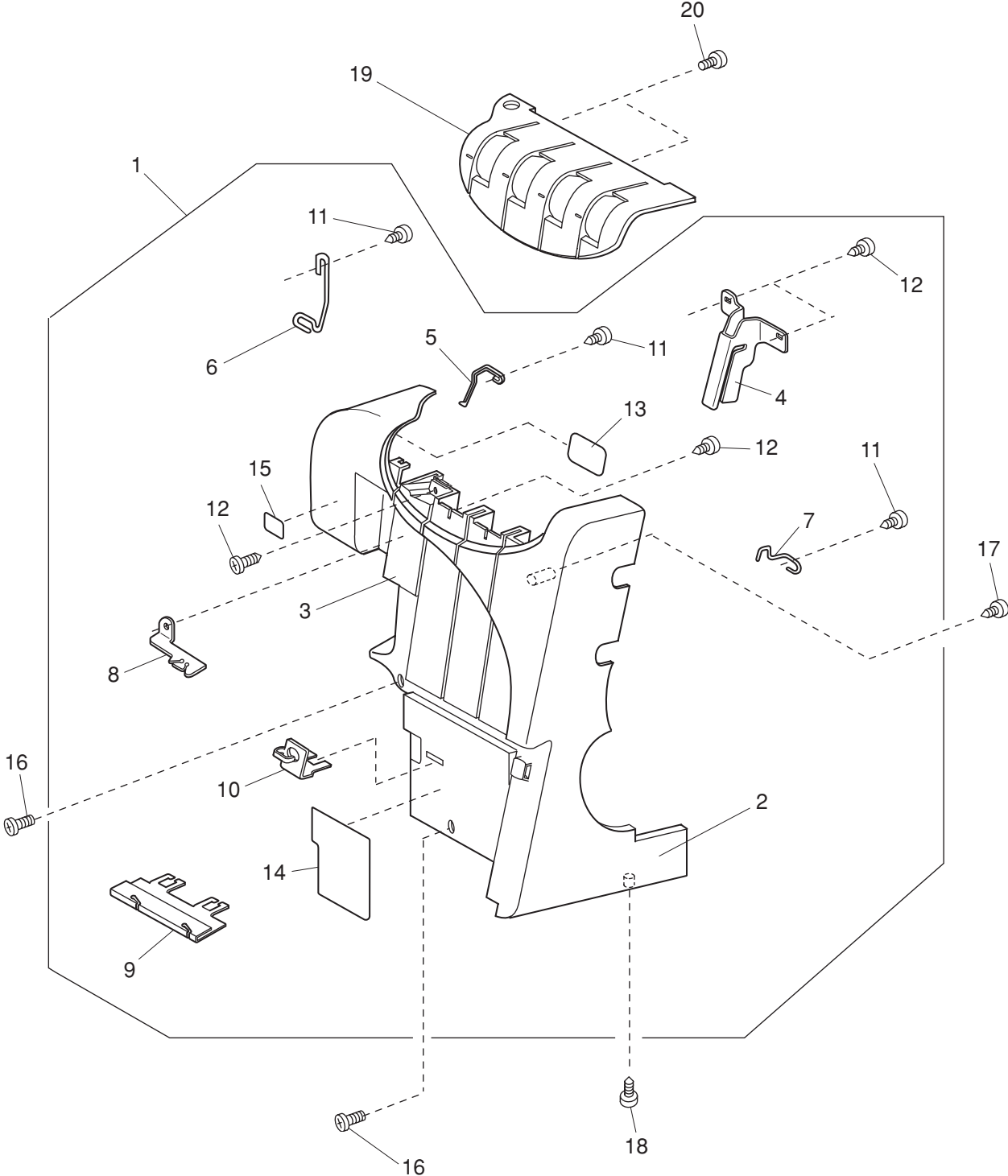

PARTS LIST

KEY NO.	PARTS NO.	DESCRIPTION
1	793603248	Front cover (unit)
2	793004A05	Front cover
3	793005004	Thread guide cover
4	788059007	Take-up lever cover
5	788060001	Needle thread guide (R)
6	788115002	Needle thread guide (L)
7	788107001	Needle thread guide
8	788063004	Needle thread guide plate
9	787132002	Looper thread guide
10	787131001	Upper looper thread guide
11	000149301	Tapping screw 3x8 (B)
12	000120203	Tapping screw 3x8 (B)
13	724025006	Reflex sticker
14	793006005	Sticker
15	888261007	Sticker
16	000081016	Setscrew 4x8
17	000161206	Tapping screw 3x10 (B)
18	000198305	Tapping screw 4x10 (B)
19	793007132	Top cover
20	000081005	Setscrew 4x8

PARTS LIST

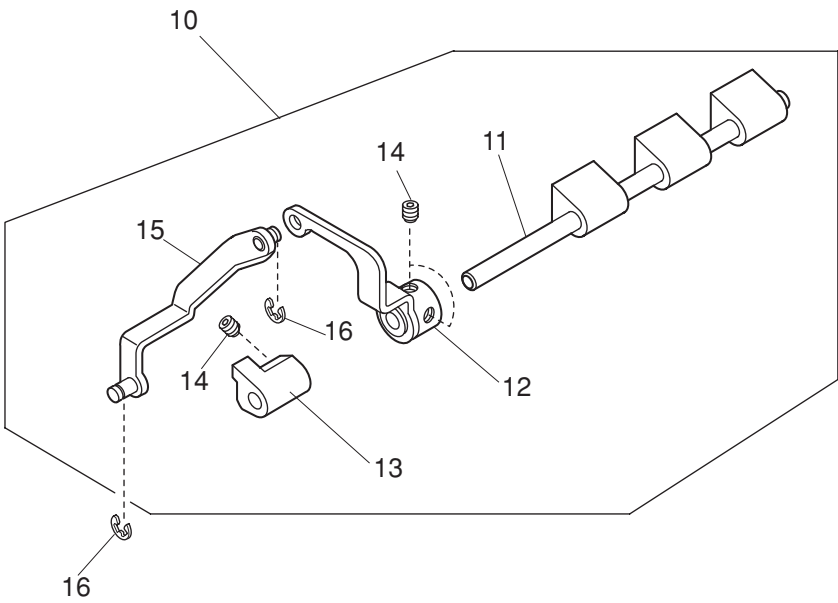
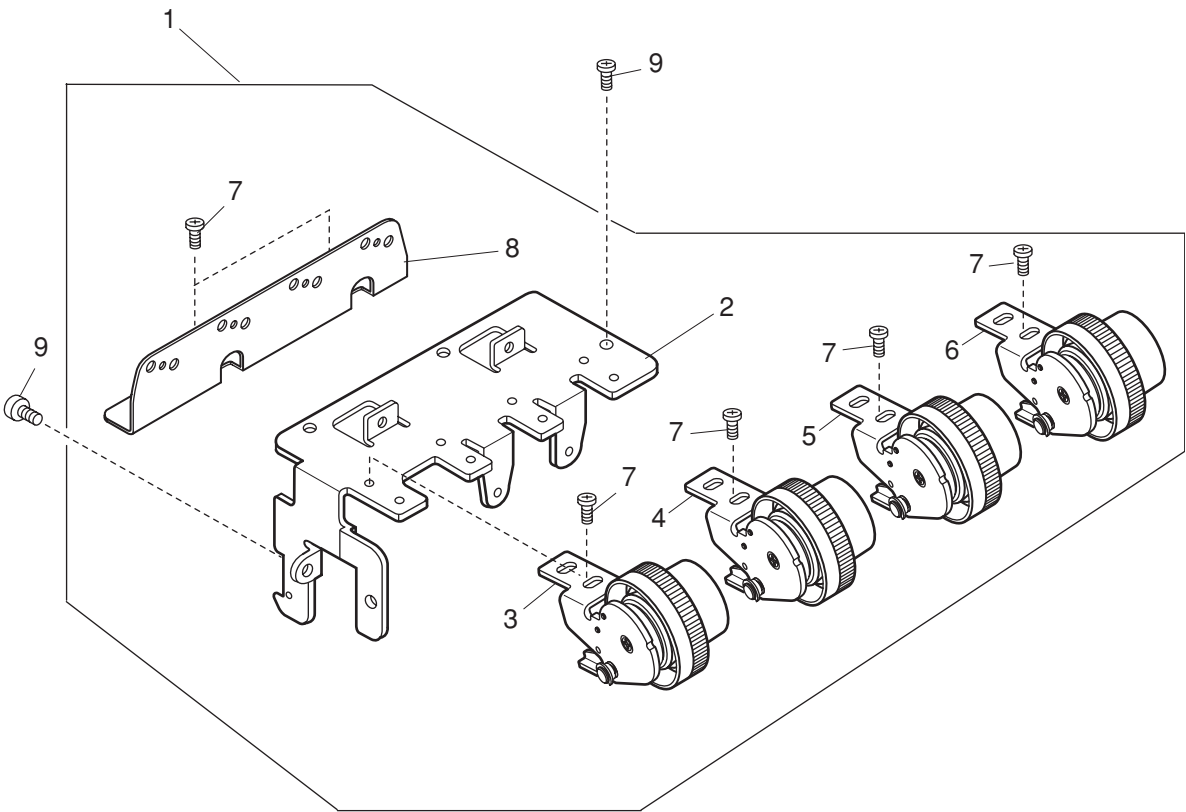

PARTS LIST

KEY NO.	PARTS NO.	DESCRIPTION
1	793602100	Thread tension set plate (unit)
2	793002001	Thread tension set plate
3	788503908	Left Needle thread tension (unit)
4	788504806	Right Needle thread tension (unit)
5	788505807	Upper looper thread tension (unit)
6	788506808	Lower looper thread tension (unit)
7	000101404	Setscrew 4x6
8	793003002	Thread guide
9	000081005	Setscrew 4x8
10	793611009	Thread tension release shaft (unit)
11	793127003	Thread tension release shaft
12	788055003	Thread tension release lever
13	788056004	Cam ring
14	000111201	H. socket screw 4x4
15	788089006	Thread tension release link
16	000002105	Snap ring E-3

PARTS LIST

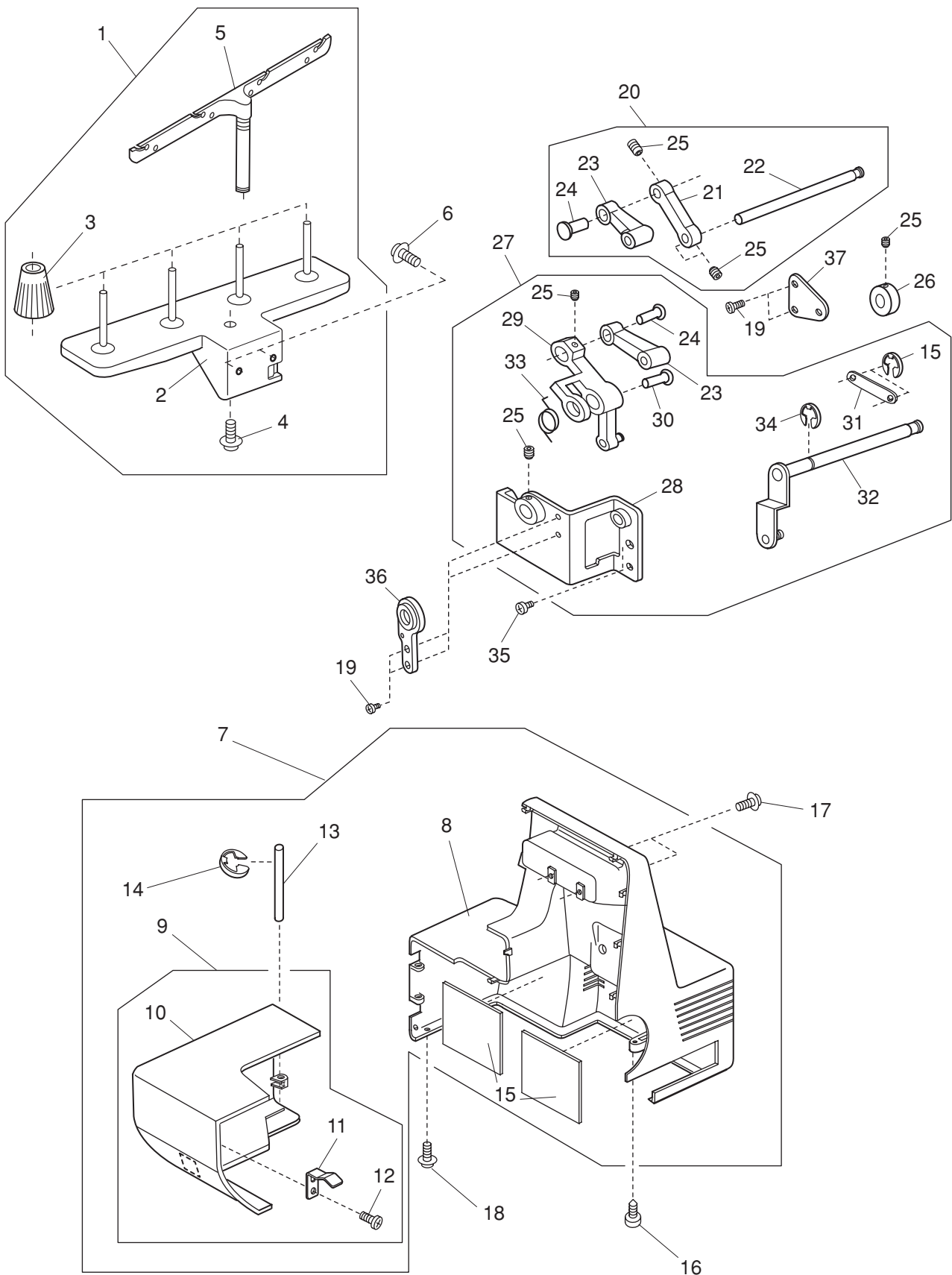

PARTS LIST

KEY NO.	PARTS NO.	DESCRIPTION
1	789606008	Spool stand (unit)
2	777011003	Spool stand
3	784223105	Spool holder
4	000115700	Setscrew TP 4x10
5	789607009	Thread guide bar (unit)
6	000109103	Setscrew 4x12
7	792615103	Back cover (unit)
8	792022107	Back cover
9	792608103	Side cover (unit)
10	792023005	Side cover
11	787163002	Side cover spring
12	000120203	Tapping screw 3x8 (B)
13	792024006	Side cover shaft
14	000002105	Snap ring E-3
15	794110006	Rubber sheet
16	000198305	Tapping screw 4x10 (B)
17	000115618	Setscrew TP 4x8
18	000115607	Setscrew TP 4x8
19	000081005	Setscrew 4x8
20	787637002	Main feed con. arm (unit)
21	787197005	Main feed con. arm 2
22	784198006	Main feed con. shaft
23	787067005	Feed link
24	787195003	Feed connecting pin
25	000111201	H. socket screw 4x4
26	650136009	Ring
27	792611202	Feed adjusting base (unit)
28	793119002	Feed adjusting base
29	787194002	Sub feed connecting arm 3
30	787195014	Connecting arm pin
31	787081005	Feed con. arm link
32	792034401	Sub feed con. arm shaft
33	798059008	Spring
34	000001609	Snap ring E-5
35	000103509	Setscrew 4x10
36	793118001	Main shaft set plate
37	787077008	Connecting arm support

PARTS LIST

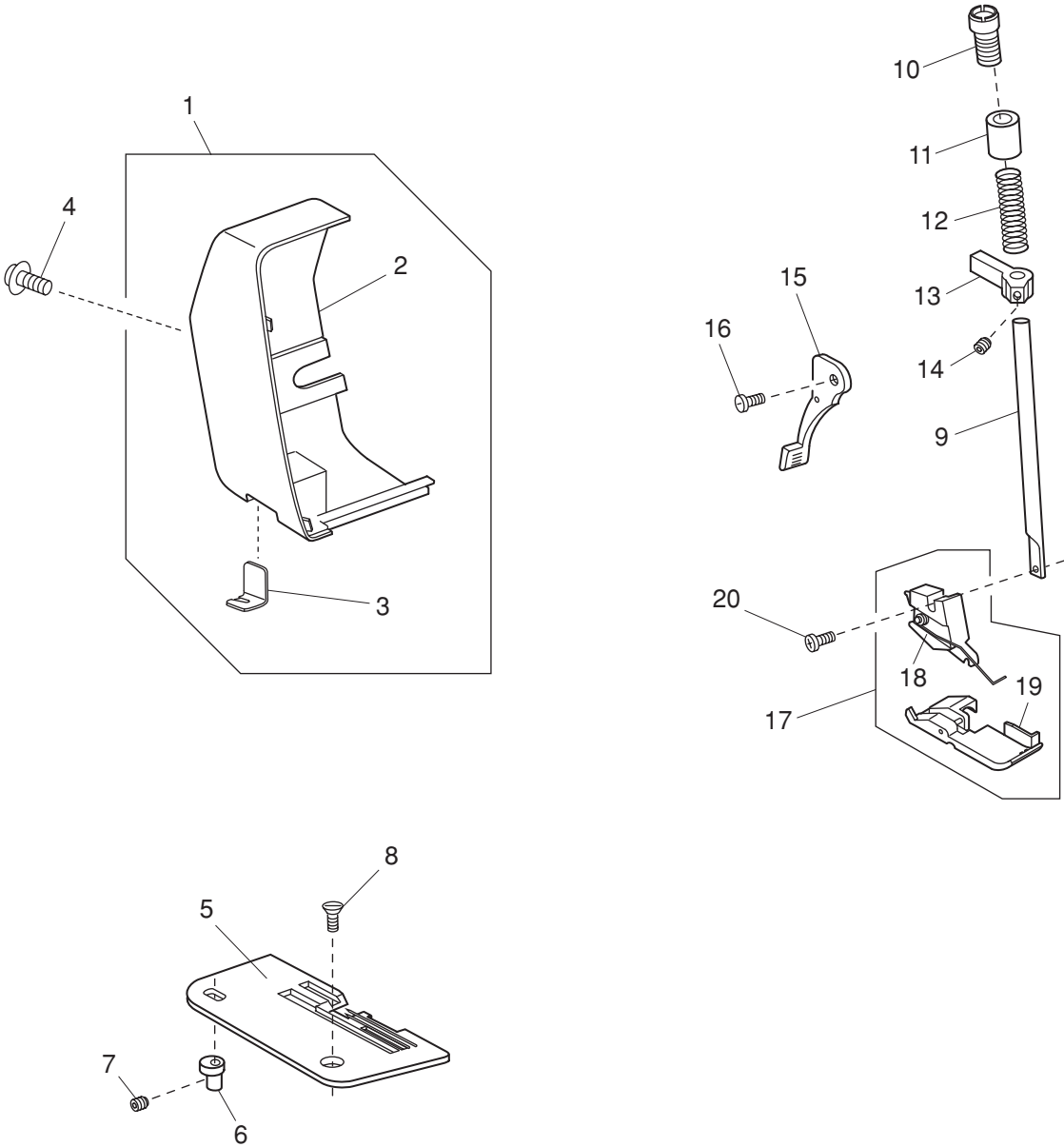

PARTS LIST

KEY NO.	PARTS NO.	DESCRIPTION
1	793601109	Face plate (unit)
2	793001000	Face plate
3	840602006	Thread cutter (unit)
4	000115700	Setscrew TP 4x10
5	788601000	Needle plate (unit)
6	789100007	Eccentric pin
7	000111902	H. socket screw 3x4
8	681009101	Plain screw
9	787019002	Presser bar
10	777013108	Presser adjusting screw
11	777002001	Presser bar bushing (upper)
12	787020006	Presser bar spring
13	789117007	Presser bar bracket
14	000111304	H. socket screw 5x5
15	650032015	Presser lifter
16	810431009	Hinge screw
17	788501009	Presser foot (unit)
18	787541008	Foot holder (unit)
19	788502000	Presser foot (lower) (unit)
20	660106001	Setscrew

PARTS LIST

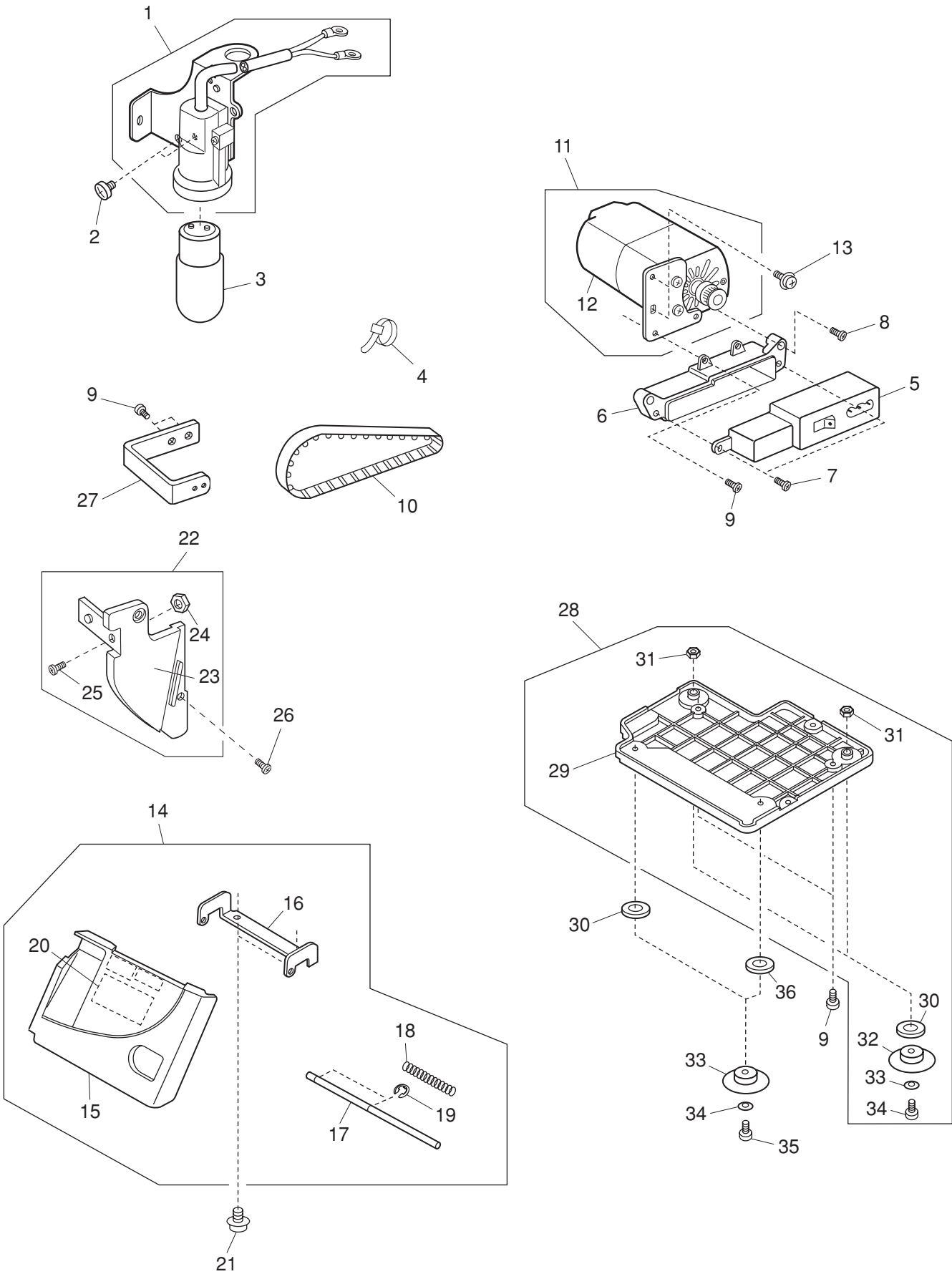

PARTS LIST

KEY NO.	PARTS NO.	DESCRIPTION
1	791620108	Lamp socket (unit)
2	000101404	Setscrew 4x6
3	000009009	Lamp 240V 15W
4	000053008	Cord binder
5	777502109	Plug con. rec. (unit)
6	784128028	Plug. con. receptacle cover
7	000121905	Tapping screw 4x12 (B)
8	000104108	Setscrew 4x20
9	000081005	Setscrew 4x8
10	793125001	Timing belt
11	792618405	Motor (unit)
12	793503007	Motor
13	000115504	Setscrew TP 5x10
14	793604342	Looper cover (unit)
15	793008410	Looper cover
16	793009008	Looper cover supporter
17	792027009	Looper cover shaft
18	792028000	Looper cover spring
19	000002105	Snap ring E-3
20	789028000	Sticker
21	000115205	Setscrew TP 4x6
22	792610005	Looper cover guide (unit)
23	792029001	Looper cover guide
24	000062402	Nut 4-2-7
25	000103510	Setscrew 4x10
26	000078320	Setscrew 3x6
27	787153009	L. cover guide supporter
28	789610049	Base plate (unit)
29	789034009	Base plate
30	787204006	Washer (2)
31	000061205	Nut 4-3-7
32	784135006	Rubber cushion
33	000070300	Washer 5
34	784169009	Hinge screw
35	785260004	Washer

PARTS LIST

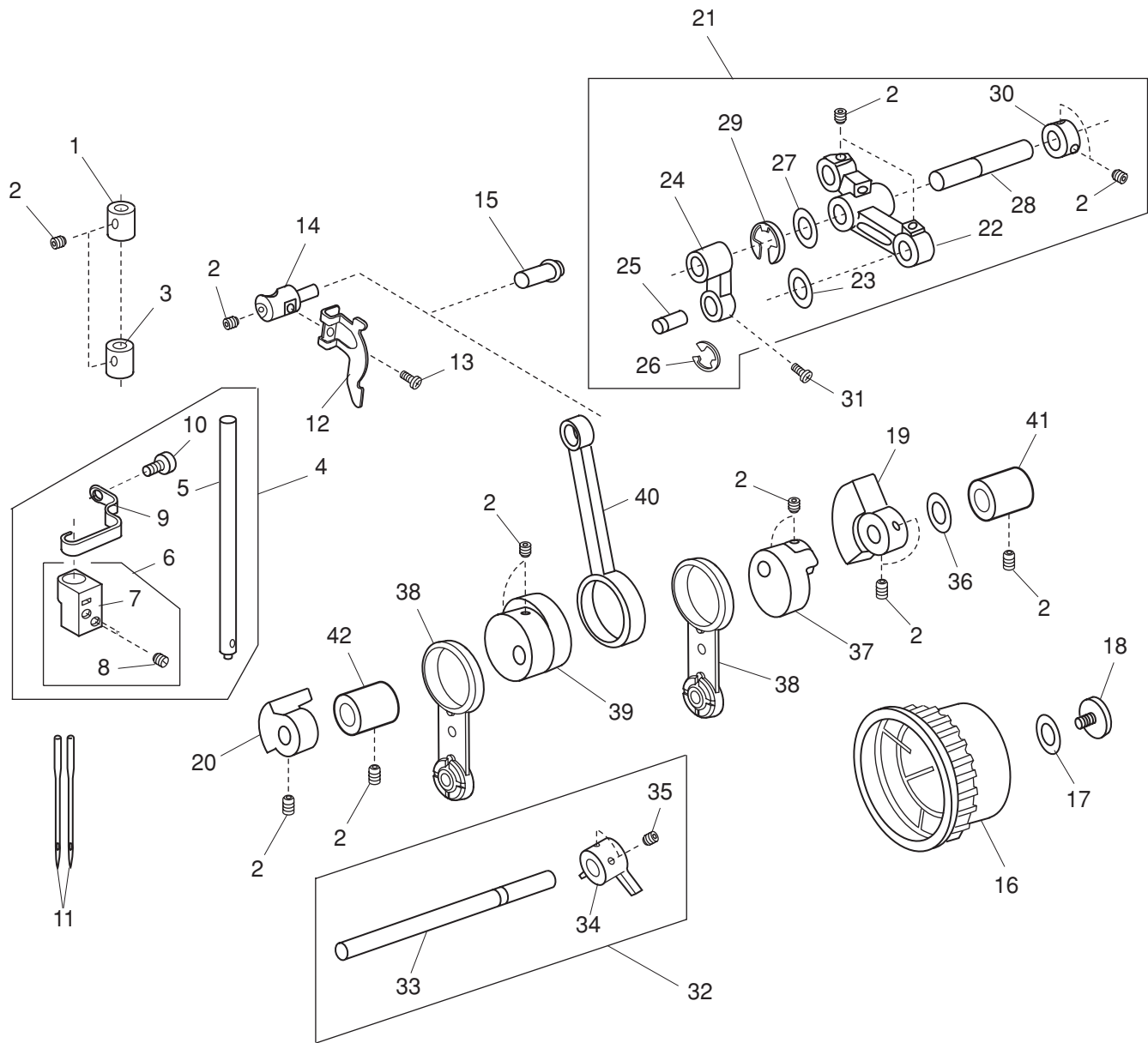

PARTS LIST

KEY NO.	PARTS NO.	DESCRIPTION
1	784027004	Needle bar upper bushing
2	000111201	H. socket screw 4x4
3	784028005	Needle bar lower bushing
4	792601003	Needle bar (unit)
5	792001007	Needle bar
6	792501002	Needle clamp (unit)
7	792002008	Needle clamp
8	888264000	Needle clamp screw
9	792003009	Needle bar thread guide
10	000078320	Setscrew 3x6
11	784157015	Needle
12	788004007	Take-up lever
13	000078319	Setscrew 3x6
14	784024001	Needle bar bracket
15	793606001	Needle bar balancer pin (unit)
16	793102002	Handwheel
17	556047007	Washer
18	618070004	Screw
19	787176101	Balance weight (right)
20	792037002	Balance weight (left)
21	789612007	Needle bar crank (unit)
22	789104001	Needle bar crank
23	000039905	Washer
24	789007003	Needle bar link
25	784022009	Link pin
26	000001609	Snap ring E-5
27	000038502	Washer
28	789008004	Needle bar crank shaft
29	000002909	Snap ring E-7
30	624245001	Ring
31	000101703	Setscrew 4x12
32	792619015	Main shaft (unit)
33	789001007	Main shaft
34	792041021	Balance weight
35	000111304	H. socket screw 5x5
36	000038605	Washer
37	787004107	Upper looper cam
38	792951001	Looper cam ring (unit)
39	787007100	Needle bar cam
40	784011005	Needle bar crank rod
41	673062004	Bushing
42	784009000	Bushing

PARTS LIST

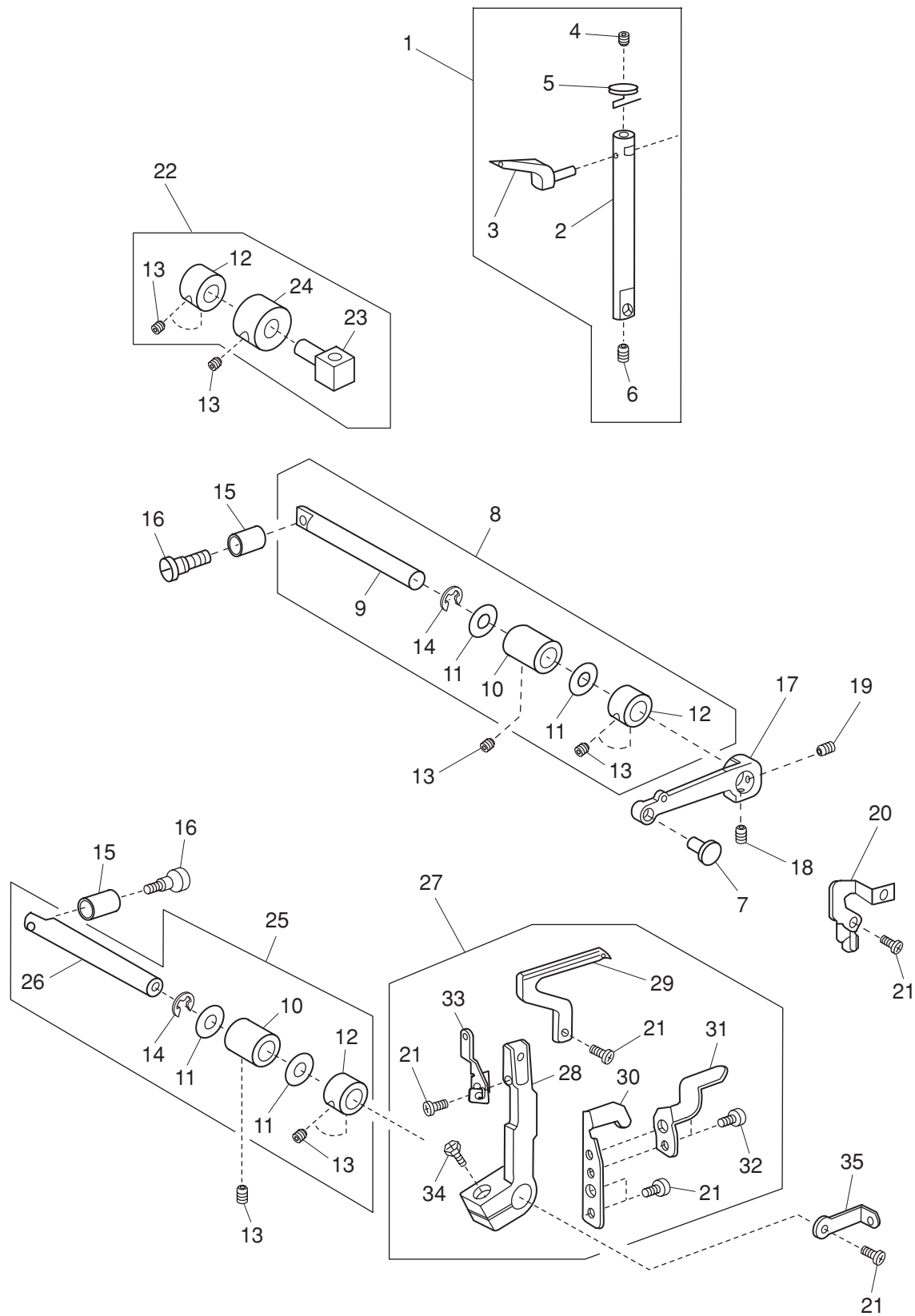

PARTS LIST

KEY NO.	PARTS NO.	DESCRIPTION
1	787618007	Upper looper shaft (unit)
2	787111005	Upper looper shaft
3	784076019	Upper looper
4	000112501	H. socket screw 4x4
5	784077009	U. looper thread guide (3)
6	000177205	H. socket screw 3x6
7	789116006	Upper looper pin
8	792633004	U. looper crank shaft (unit)
9	787105006	U. looper crank shaft
10	787104005	Bushing
11	000038502	Washer
12	792048006	Ring
13	000111201	H. socket screw 4x4
14	000002806	Snap ring E-6
15	787107101	Crank spacer
16	787108009	Crank setscrew
17	789112002	U. looper waving arm
18	000111304	H. socket screw 5x5
19	000110107	H. socket screw 5x5 (WP)
20	788038000	Looper thread guide (L2)
21	000078320	Setscrew 3x6
22	792614009	U. looper shaft guide (unit)
23	792038003	U. looper shaft guide
24	792039004	Bushing
25	792634005	L. looper crank shaft (unit)
26	787116000	L. looper crank shaft
27	785610036	Lower looper (unit)
28	785024004	L. looper base (2)
29	784083606	Lower looper
30	787383000	Rear needle guard
31	785023003	Front needle guard
32	000099006	H. socket screw 3x4
33	784085206	L. looper thread guide (3)
34	000138008	H. socket screw 4x16
35	785010203	L. looper thread guide

PARTS LIST

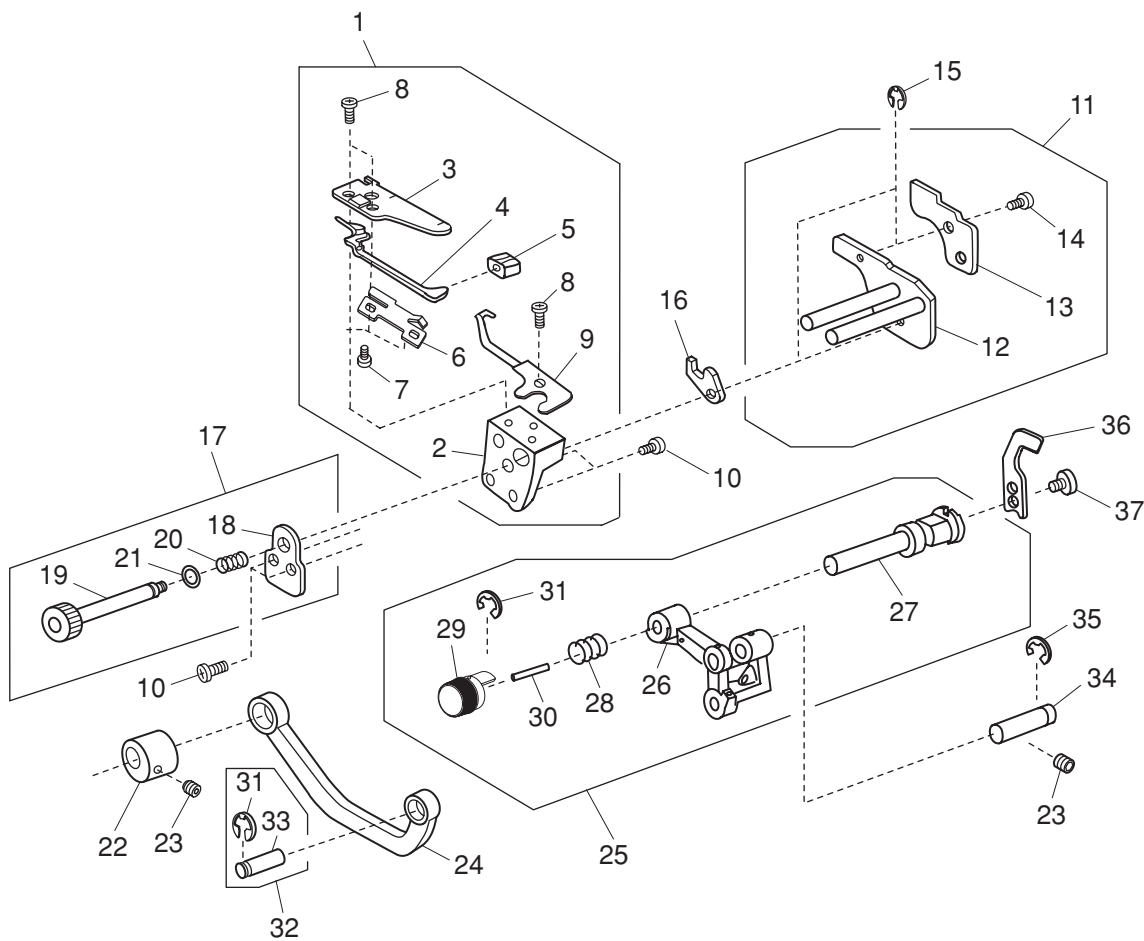

PARTS LIST

KEY NO.	PARTS NO.	DESCRIPTION
1	792613008	Chaining finger bracket (unit)
2	788015001	Chaining finger bracket
3	789106003	Chaining finger set plate
4	788017003	Chaining finger
5	787041003	Needle plate setting knob
6	788018004	Chaining finger spring
7	000074603	Setscrew 2x4-2
8	000078320	Setscrew 3x6
9	788019005	Fixed needle guard
10	000081005	Setscrew 4x8
11	792603005	Lower knife (unit)
12	792005001	Lower knife set plate
13	788013009	Lower knife
14	000102221	Setscrew 4x6
15	000001207	Snap ring E-2.5
16	788021000	Guide shaft nut
17	792622000	Lower knife guide shaft (unit)
18	787046008	Guide plate
19	792007003	Lower knife guide shaft
20	787048000	Spring
21	000036500	Washer
22	788008001	Upper knife drive cam
23	000111201	H. socket screw 4x4
24	789009005	Upper knife connecting rod
25	793613218	Upper knife drive arm (unit)
26	793105304	Upper knife drive arm
27	793107007	Upper knife supporter
28	793124000	Spring
29	793130009	Upper knife knob
30	000022802	Spring pin 2x12
31	000001609	Snap ring E-5
32	793615003	Pin (unit)
33	793129005	Pin
34	787022101	Pin
35	000002909	Snap ring E-7
36	788127007	Upper knife
37	624303008	H. bolt 4x6

PARTS LIST

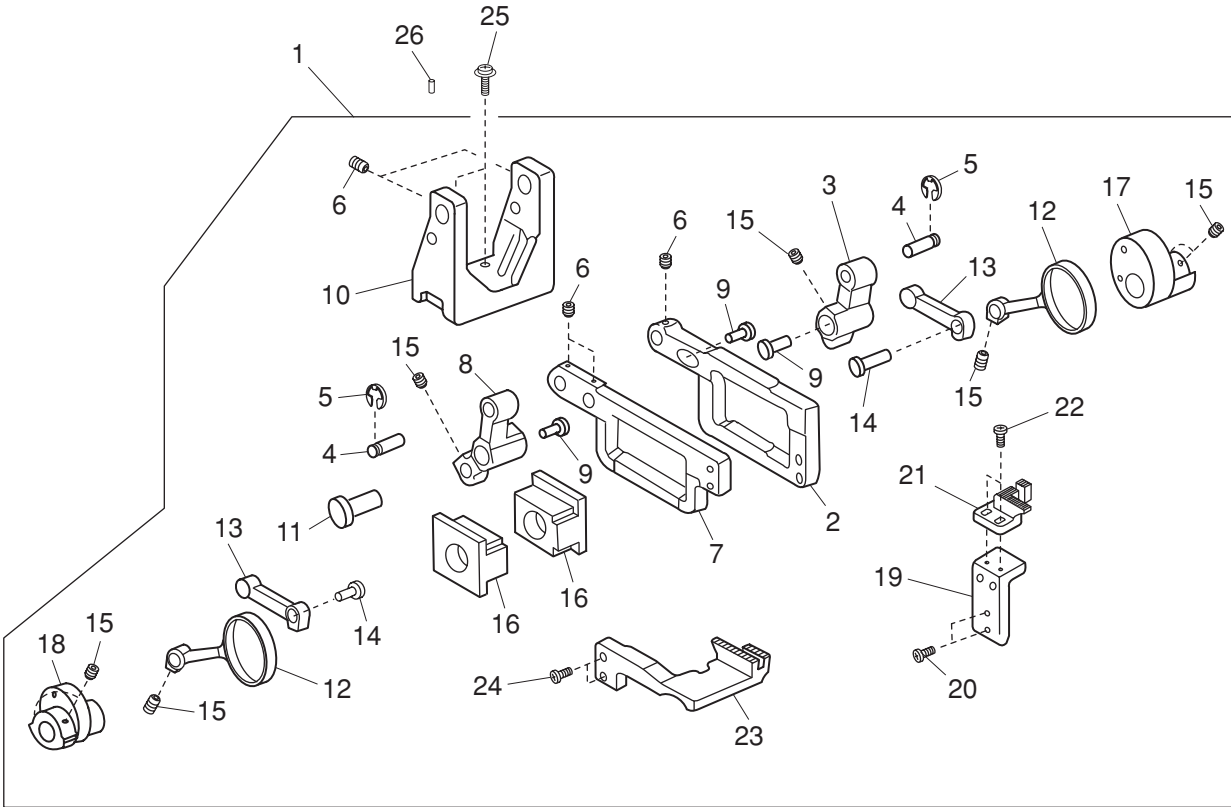

PARTS LIST

KEY NO.	PARTS NO.	DESCRIPTION
1	792604006	Feed bar (unit)
2	788022001	Main feed bar
3	787054009	Main feed bar drive arm
4	787224002	Pin
5	000002507	Snap ring E-4
6	000111902	H. socket screw 3x4
7	788024003	Sub feed bar
8	787212007	Sub feed drive arm
9	787059004	Pin
10	787305008	Feed bar base
11	787306009	Feed driving arm pin
12	787065003	Feed bar link
13	787066004	Feed rocking link
14	787068006	Pin
15	000111201	H. socket screw 4x4
16	792008004	Block
17	787072003	Main feed drive cam
18	787073004	Sub feed drive cam
19	788023002	Main feed dog bracket
20	000068811	Setscrew 3.5x10
21	788027006	Main feed dog
22	000066705	Setscrew 3x8
23	789018007	Sub feed dog
24	000104201	Setscrew 3.5x10
25	000201405	Setscrew TP 4x16
26	000005304	Spring pin 3x8

PARTS LIST

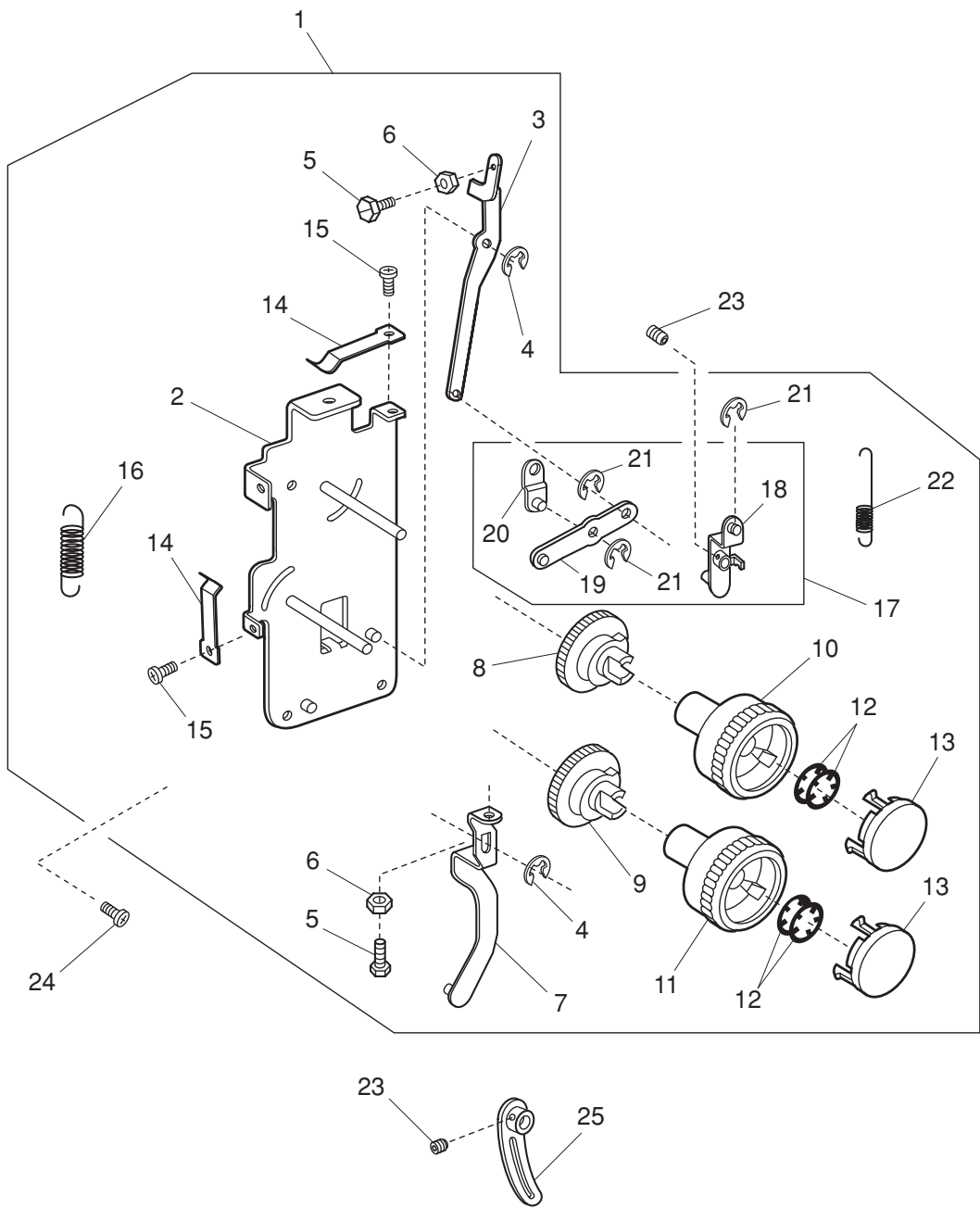

PARTS LIST

KEY NO.	PARTS NO.	DESCRIPTION
1	792606008	Feed adjuster (unit)
2	792012001	Set plate
3	792013002	Feed rod
4	000001609	Snap ring E-5
5	785224006	Adjustable screw
6	000160102	Adjustable lock nut 4
7	792014003	Differential rod
8	792015004	S. length adj. cam
9	788036008	Dif. adj. cam
10	792016108	S. length dial
11	792016153	Dif. dial
12	000013800	Snap ring CS-6
13	787262301	S. length dial cap
14	787263003	Spring
15	000081119	Setscrew 4x6
16	787259006	Spring
17	792605007	Main feed con. arm (unit)
18	792040008	Main feed con. arm
19	787266006	Feed con. plate
20	788031003	Dif. transfer arm
21	000002105	Snap ring E-3
22	792011000	Spring
23	000111201	H. socket screw 4x4
24	000081005	Setscrew 4x8
25	788032107	Sub feed con. arm

PARTS LIST

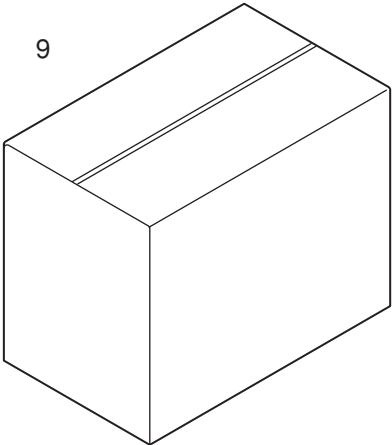
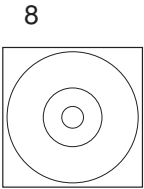
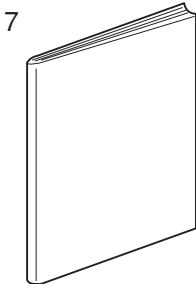
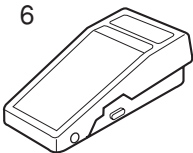
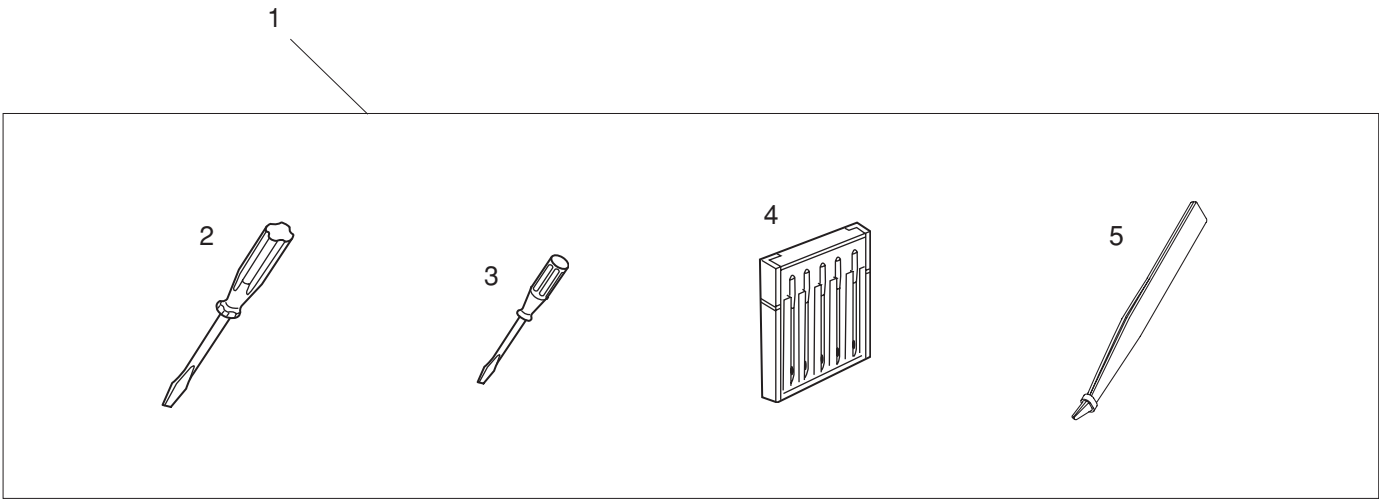

PARTS LIST

KEY NO.	PARTS NO.	DESCRIPTION
1	793870101	Accessories (unit)
2	784810002	Screwdriver (large)
3	792030005	Screwdriver (small)
4	784860100	Needle case (unit)
5	624801001	Tweezer
6	C-2060	Foot control
7	793800214	Instruction book (English/Spanish/French)
8	793807004	Instruction DVD
9	785808103	Cover